



Citizens Bond Oversight Committee Quarterly Report August 10, 2020

Santa Ana Unified School District

1601 E. Chestnut Avenue, Santa Ana, CA 92701

(714) 558-5501 www.sausd.us



Intentionally left blank



IN LOVING MEMORY OF MR. ROB RICHARDSON



Santa Ana Unified School District mourns the passing of former Board President Rob Richardson. We are grateful for his many years of service to our community. Mr. Richardson was a member of the SAUSD Board of Education and currently a member of the SAUSD Measure I Citizens' Bond Oversight Committee. He was also the current President of the Santa Ana Public Schools Foundation Board of Directors. He loved Santa Ana and was an advocate of education.

Throughout his life, he was active in many organizations in our city and county, holding a variety of roles. Mr. Richardson was a member of the City Council and served on the Planning Commission, Historic Resources Commission, Kiwanis Club, Boys and Girls Club, and was a member of the Santa Fe Railway Historical Modeling Society, where a courtyard at the Santa Ana Regional Transportation Center was named in his honor. He will be greatly missed for his leadership and dedication.



Mr. Richardson was raised in Santa Ana. He attended Wilson Elementary, Willard Intermediate and graduated from Santa Ana High School. He received his bachelor's degree from UCLA. He passed away on July 26, 2020, of natural causes. He is survived by his wife, Bellavadey, and four children: Kala, Cameron, Lia and Ian.



Intentionally left blank



Measure I Overview

On November 6, 2018, the voters of the Santa Ana Unified School District approved Measure I, authorizing General Obligation Bonds (the “Bonds”) with a 70.65% approval rate. Measure I generates \$232 million dollars over the next 10-15 years to improve and build new classrooms and support facilities in the District.

The Facilities Master Plan adopted by the District’s Board of Education in 2018 will serve as the guide to plan projects funded by Measure I. School needs are based on overall condition, educational program requirements, capacity, and available State funding. The Bonds will be used to modernize classrooms and buildings with accessibility improvements and safety upgrades, as well as to repair and upgrade aging school infrastructure, replace portable classrooms with permanent facilities, and keep schools ahead of the demands of 21st Century learning environments.

Committee Members

- ❖ Victor Vasquez – Chair
- ❖ Denise Lynn Reynoso – Vice Chair
- ❖ Elaine Beverly Hoffmann – Member
- ❖ Rob Richardson – Member
- ❖ Lucinda Solorzano – Member
- ❖ Valery Vasquez – Member
- ❖ Bulmaro Vicente – Member



Four Pillars

The Facilities Master Plan was guided by a “Four Pillars” concept to meet the needs of aging schools so that our community keeps pace with rising academic standards and opportunities to compete in the 21st Century.

Projects identified by the Facilities Master Plan generally correspond to one or more of the priorities described below.



Modernization:

The State Modernization Program provides State funds on a 60/40 State and local share basis for improvements that educationally and functionally enhance existing school facilities. Projects eligible under this program include Americans with Disability Act improvements, modifications such as air conditioning, plumbing, lighting, electrical systems, and interior finishes. Bond funds will be used to leverage State dollars and improve age-eligible schools.

Portable to Permanent (P2P):

The replacement of antiquated portables with state-of-the-art classroom learning environments help save on maintenance and energy costs and recapture open space for student play and community use. Combining State Overcrowded Relief Grant (ORG) fund savings and bond funds allow for projects including, but not limited to:

- ❖ Carver Elementary P2P
- ❖ Muir Elementary P2P
- ❖ Jefferson Elementary P2P



Infrastructure:

The replacement or improvement of antiquated building systems such as HVAC, plumbing, electrical, fire alarms, and other critical functions help reduce the District's maintenance burden and thus sustain the District's General Fund for educational programs. A focus of bond funds will be:

- ❖ Enhancing student and staff safety and security
- ❖ Improving services to clients (students, faculty and staff)
- ❖ Reducing interruptions to education delivery

Campus Equity:

Our schools were built over many generations, all with a variety of features and functions that vary by location. Funds will be used to provide facilities which serve all of our District community and correct inequities between campuses to keep them on par with peer schools. Goals include:

- ❖ Safe, effective, and well-maintained learning environments
- ❖ Facilities that maintain and attract enrollment and which support and enhance academic achievement
- ❖ Opportunities for parent involvement and community services

Available Funding

Measure I represents approximately 10% of the District's identified need. Within the \$232 million authorized by Measure I, about 25%, or \$59.5 million, is available for current projects.

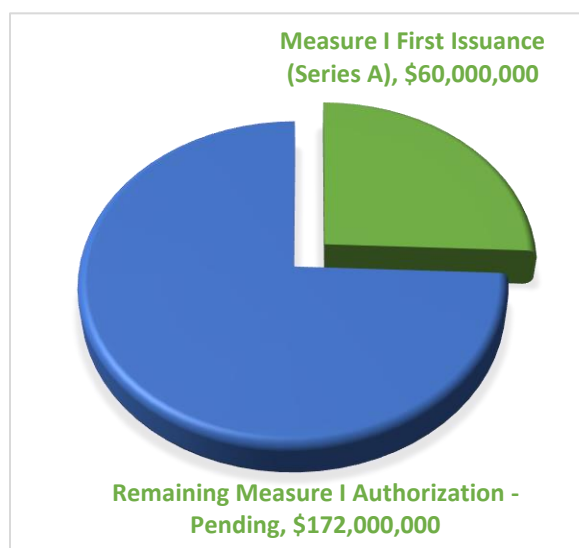
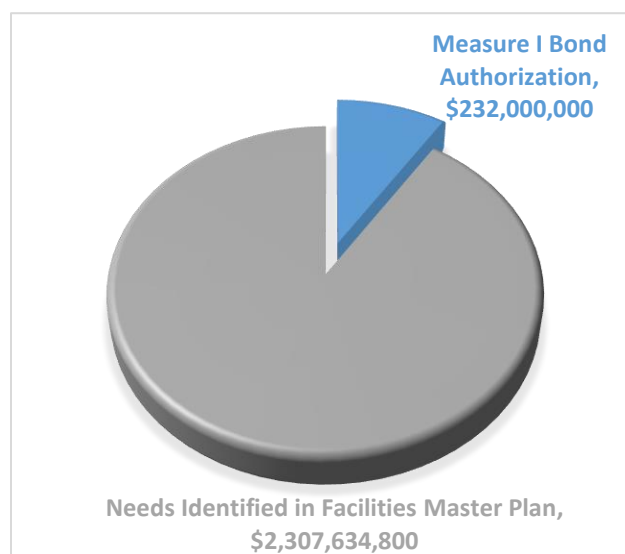



Intentionally left blank



Santa Ana High School

520 W. Walnut St. Santa Ana, CA 92701

New Library and CTE Digital Media Arts Lab

Project Description

The District's goal for moving forward with this project was to provide an exemplary Career Technical Education (CTE) environment. The project began on September 24, 2018, and was completed on September 1, 2019. The Digital Media Arts Lab and library are now being used by students and staff.

Architect:	Baker Nowicki Design Studio
DSA Status:	Approved
Project Status:	Complete
Measure I Budget:	\$47,734
Total Budget:	\$5,273,368

Status Summary

The Santa Ana High School New Library and CTE Digital Media Arts Lab project is complete with DSA close out.



Santa Ana High School

520 W. Walnut St. Santa Ana, CA 92701

New Library and CTE Digital Media Arts Lab

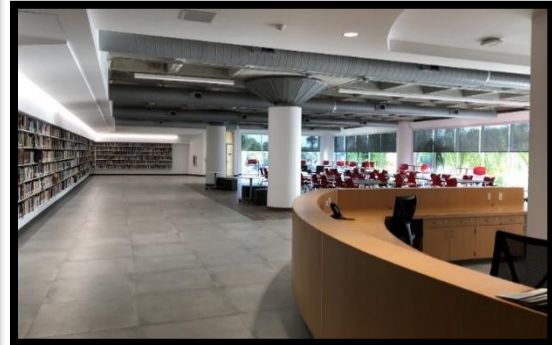



Santa Ana High School

520 W. Walnut St. Santa Ana, CA 92701

New Library and CTE Digital Media Arts Lab

Summary Status

Description	Budgeted	Committed	Expended
Site Cost	-	-	-
Soft Cost	675,865	675,865	675,865
Hard Cost	4,597,503	4,597,503	4,597,503
Contingency	-	-	-
Total	5,273,368	5,273,368	5,273,368
Budgeted Hard Cost	87%		

Budget Status

Initial Amount	5,273,368
Pending Changes	-
Total	5,273,368
Budgeted Contingency	0%

Committed Status

Initial Contracted AMT	5,287,852
Contract Changes	(14,484) 0%
Total	5,273,368
Budget Committed	100%

Expenditure Status

Paid	5,273,368
Total	5,273,368
Budget Expended	100%

Progress

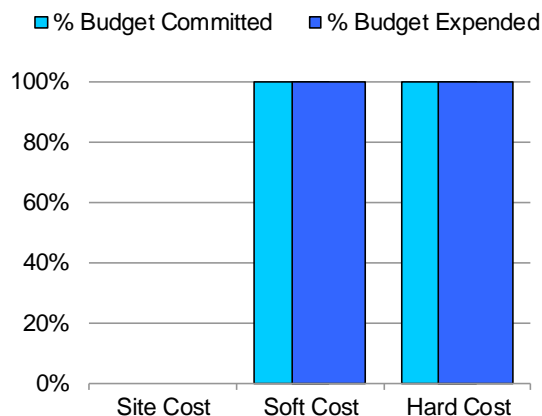

Funding Sources

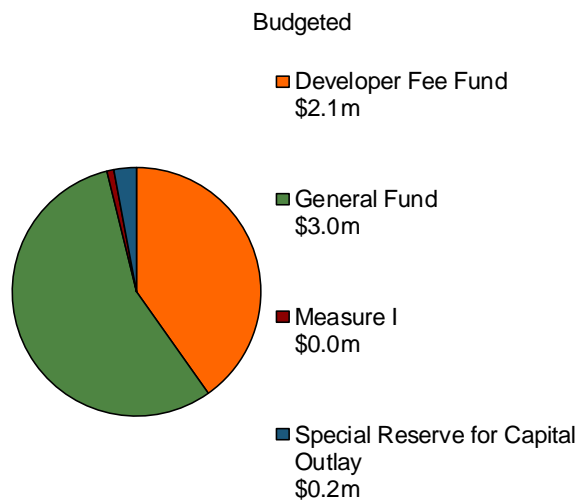



Carver Elementary School

1401 W. Santa Ana Blvd., Santa Ana, CA 92703

Portable to Permanent (P2P)

Project Description

The Carver P2P project consists of a new 2-story classroom building with 8 classrooms. The project also provides expanded play areas, an artificial turf play field, new play structures, and additional parking.

Architect:	Morrissey Associates, Inc.
Construction Manager:	Tilden-Coil Constructors, Inc.
DSA Status:	Approved
Project Status:	Complete
Measure I Budget:	\$30,820
Total Budget:	\$11,089,158

Status Summary

The Carver P2P project is complete and pending DSA close out.



Carver Elementary School

1401 W. Santa Ana Blvd., Santa Ana, CA 92703

Portable to Permanent (P2P)





Carver Elementary School

1401 W. Santa Ana Blvd., Santa Ana, CA 92703

Portable to Permanent (P2P)

Summary Status

Description	Budgeted	Committed	Expended
Site Cost	18,259	18,259	18,259
Soft Cost	2,233,502	2,233,502	2,190,938
Hard Cost	8,812,521	8,812,521	8,812,521
Contingency	24,876	-	-
Total	11,089,158	11,064,282	11,021,719
Budgeted Hard Cost 79%			

Budget Status

Initial Amount	11,089,158
Pending Changes	-
Total	11,089,158
Budgeted Contingency 0%	

Committed Status

Initial Contracted AMT	10,886,901
Contract Changes	177,381 2%
Total	11,064,282
Budget Committed 100%	

Expenditure Status

Paid	11,007,214
In Process for PMT	14,505
Total	11,021,719
Budget Expended 99%	

Progress

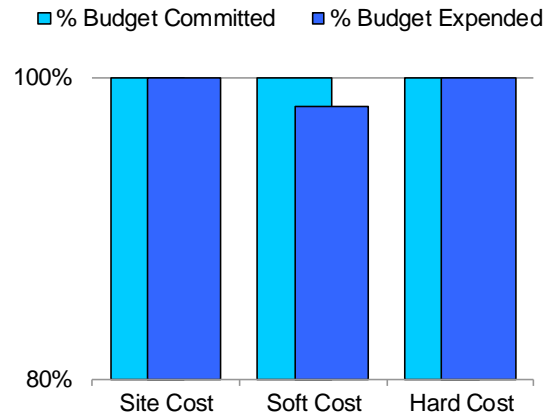

Funding Sources

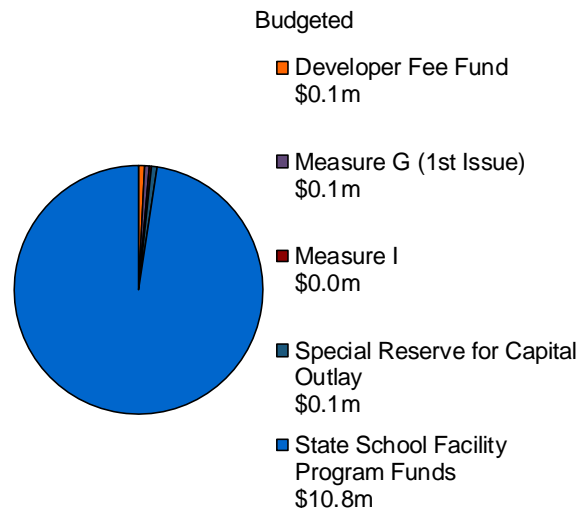



Carver Elementary School

1401 W. Santa Ana Blvd., Santa Ana, CA 92703

Modernization

Project Description

Carver Elementary School was originally built in 1992. The site has 21 classrooms. Carver's modernization project consists of alterations to Building A (administration); Building B (multipurpose); and Buildings E, F, G (classrooms).

Architect:	Morrissey Associates, Inc.
Construction Manager:	Tilden Coil Constructors, Inc.
DSA Status:	Approved
Project Status:	Construction began on February 13, 2020
Measure I Budget:	\$8,815,632
Total Budget:	\$9,577,806

Status Summary

The Carver Modernization Project was DSA approved in late 2018. The project began construction on February 13, 2020, and will be completed by January 2021. The contractors are finalizing the interior finishes and final clean up.



Carver Elementary School

1401 W. Santa Ana Blvd., Santa Ana, CA 92703

Modernization





Carver Elementary School

1401 W. Santa Ana Blvd., Santa Ana, CA 92703

Modernization

Summary Status

Description	Budgeted	Committed	Expended
Site Cost	-	-	-
Soft Cost	2,296,433	1,982,950	1,346,327
Hard Cost	6,335,058	5,264,288	3,418,780
Contingency	946,315	-	-
Total	9,577,806	7,247,238	4,765,107
Budgeted Hard Cost 66%			

Budget Status

Initial Amount	9,577,806
Approved Changes	-
Pending Changes	-
Total	9,577,806
Budgeted Contingency 10%	

Committed Status

Initial Contracted AMT	6,692,115	
Contract Changes	502,541	7%
Unencumbered Contract AMT	52,582	
Total	7,247,238	
Budget Committed 76%		

Expenditure Status

Paid	2,533,992
In Process for PMT	2,154,411
District Held Retentions	76,705
Total	4,765,107
Budget Expended 50%	

Progress

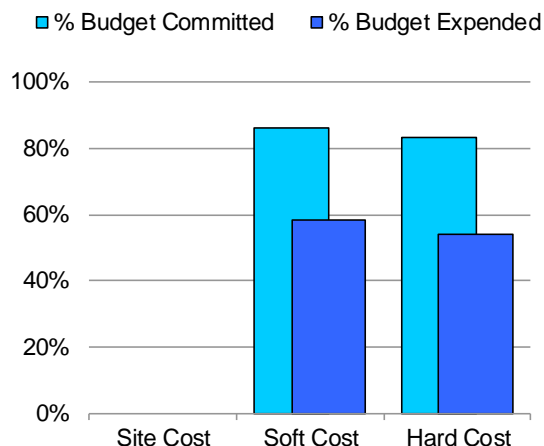

Funding Sources

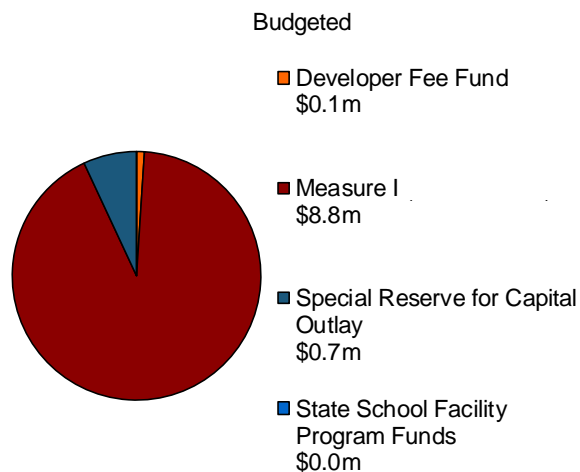



Muir Fundamental Elementary School

1951 N. Marbury St. Santa Ana, CA 92705

Portable to Permanent (P2P)

Project Description

Muir Fundamental Elementary School was originally built in 1970. The site currently has 22 aging portable classrooms. This project consists of a state-of-the-art new “Portable to Permanent” classroom building providing 22 standard classrooms with 4 multi-function “STEM” collaboration/ pull out rooms. It also includes removal of old portable classrooms and an expanded playfield.

Architect:	DLR Group
Construction Manager:	Balfour Beatty
DSA Status:	Approved
Project Status:	Construction began October 14, 2019
Measure I Budget:	\$759,154
Total Budget:	\$20,759,154

Status Summary

As of July 15, 2020, construction of the John Muir P2P building is 90% completed. Current construction consists of exterior site work and interior finishes scheduled to be completed by July 31, 2020. Portable classrooms are scheduled to be relocated the week of August 3, 2020 through August 7, 2020, with occupancy into the new building scheduled for August 10, 2020.



Muir Fundamental Elementary School

1951 N. Marbury St. Santa Ana, CA 92705

Portable to Permanent (P2P)





Muir Fundamental Elementary School

1951 N. Marbury St. Santa Ana, CA 92705

Portable to Permanent (P2P)

Summary Status

Description	Budgeted	Committed	Expended
Site Cost	-	-	-
Soft Cost	2,808,978	2,786,593	2,656,955
Hard Cost	16,484,397	16,484,396	13,045,250
Contingency	1,465,779	-	-
Total	20,759,154	19,270,989	15,702,205
Budgeted Hard Cost	79%		

Budget Status

Initial Amount	20,759,154
Pending Changes	-
Total	20,759,154
Budgeted Contingency	7%

Committed Status

Initial Contracted AMT	20,006,317
Contract Changes	(735,327) -4%
Total	19,270,989
Budget Committed	93%

Expenditure Status

Paid	14,112,344
In Process for PMT	1,332,357
District Held Retentions	257,504
Total	15,702,205
Budget Expended	76%

Progress

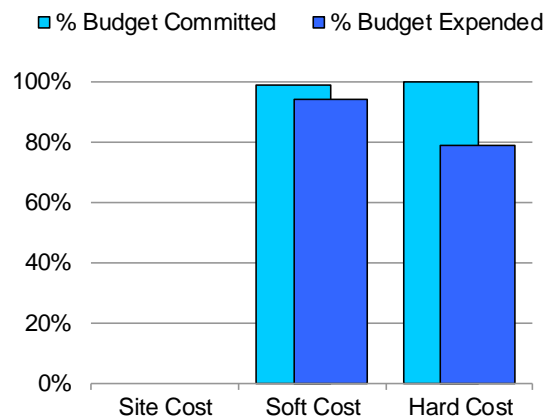

Funding Sources

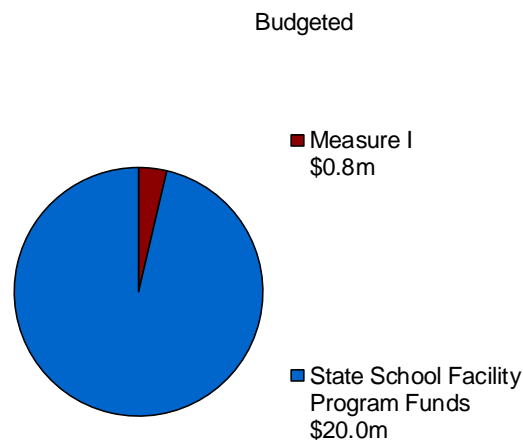



Walker Elementary School

811 E. Bishop St. Santa Ana, CA 92701

Optimization – Swing Space

Project Description

This Campus Optimization project converts Walker Elementary School to an interim housing site to provide interim classrooms to schools under construction.

Architect:	Morrissey Associates, Inc.
Construction Manager:	Tilden Coil Constructors
Project Status:	Complete
Measure I Budget:	\$1,788,970
Total Budget:	\$1,788,970

Status Summary

Ten portable classrooms and one portable restroom building is scheduled to be complete on July 24, 2020, and prepared for occupancy during the week of August 10, 2020.



Walker Elementary School

811 E. Bishop St. Santa Ana, CA 92701

Optimization – Swing Space

Summary Status

Description	Budgeted	Committed	Expended
Site Cost	-	-	-
Soft Cost	323,693	323,693	157,722
Hard Cost	1,412,191	1,312,191	586,059
Contingency	53,086	-	-
Total	1,788,970	1,635,884	743,781
Budgeted Hard Cost 79%			

Budget Status

Initial Amount	1,788,970
Pending Changes	-
Total	1,788,970
Budgeted Contingency 3%	

Committed Status

Initial Contracted AMT	1,635,884
Contract Changes	- 0%
Total	1,635,884
Budget Committed 91%	

Expenditure Status

Paid	75,062
In Process for PMT	644,724
District Held Retentions	23,995
Total	743,781
Budget Expended 42%	

Progress

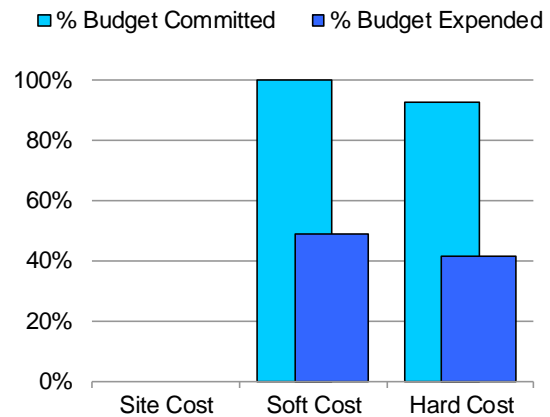

Funding Sources

Budgeted





Heninger K-8 School

417 W. Walnut Ave. Santa Ana, CA 92701

K-8 Expansion / Music & Dance Classrooms

Project Description

Heninger K-8 School serves grades K-8 in its main campus as well as Building 8 at Santa Ana High School. This project provides modern dance and music classrooms as well as support space for upper grade students.

Architect:	Baker Nowicki Design Studio
DSA Status:	Approved
Project Status:	Construction began on March 1, 2020
Measure I Budget:	\$2,470,795
Total Budget:	\$2,728,121

Status Summary

This project began in March 2020, and is scheduled to be complete by December 2020. Contractors have finished all of the utility rough ins and they proceeded with closing the walls and interior finishes.



Heninger K-8 School

417 W. Walnut Ave. Santa Ana, CA 92701

K-8 Expansion / Music & Dance Classrooms

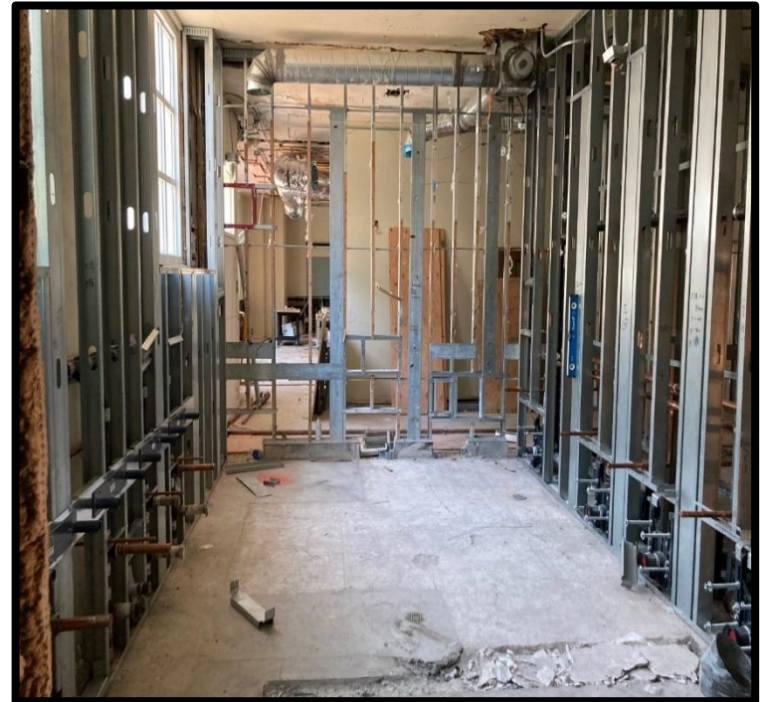



Heninger K-8 School

417 W. Walnut Ave. Santa Ana, CA 92701

K-8 Expansion / Music & Dance Classrooms

Summary Status

Description	Budgeted	Committed	Expended
Site Cost	-	-	-
Soft Cost	524,577	524,577	278,475
Hard Cost	2,203,543	2,203,543	445,870
Contingency	1	-	-
Total	2,728,121	2,728,120	724,345
Budgeted Hard Cost 81%			

Budget Status

Initial Amount	2,728,121
Pending Changes	-
Total	2,728,121
Budgeted Contingency 0%	

Committed Status

Initial Contracted AMT	2,728,120
Contract Changes	- 0%
Total	2,728,120
Budget Committed 100%	

Expenditure Status

Paid	490,128
In Process for PMT	211,923
District Held Retentions	22,294
Total	724,345
Budget Expended 27%	

Progress

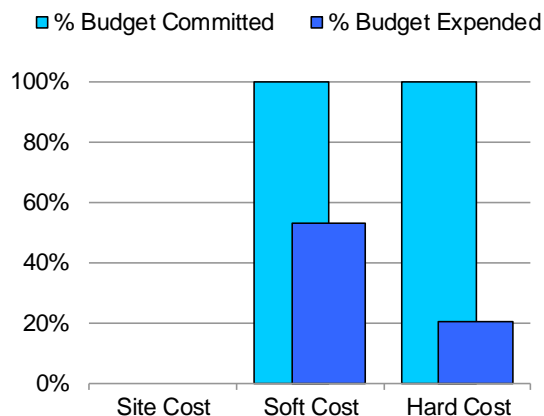

Funding Sources

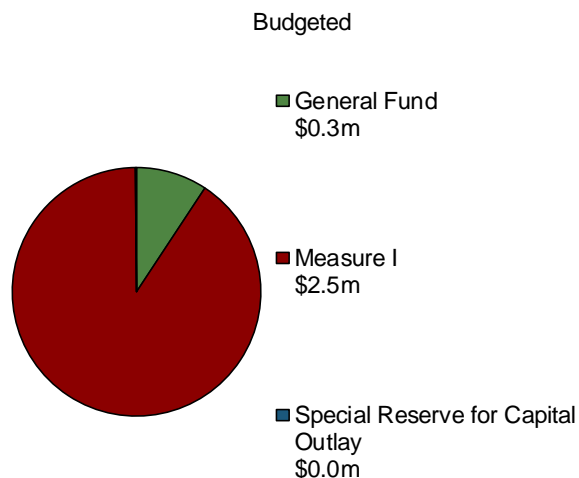



Jackson Elementary School

1143 Nakoma Dr. Santa Ana, CA 92704

Preschool Lab Classrooms & New Playground

Project Description

Jackson Elementary School was built in 1962 and also has a new classroom building built in 2009. This project will convert one of the older classroom wings into preschool classrooms. New Kindergarten and Preschool playgrounds will also be added.

Architect:	Lionakis Architecture
DSA Status:	Approved
Project Status:	Bidding
Measure I Budget:	\$1,881,565
Total Budget:	\$1,881,565

Status Summary

This project started June 2020, and is scheduled to be complete by December 18, 2020. The contractor completed the interior and exterior demolition and proceeded with the new playground and classroom infrastructure.



Jackson Elementary School

1143 Nakoma Dr. Santa Ana, CA 92704

Preschool Lab Classrooms & New Playground





Jackson Elementary School

1143 Nakoma Dr. Santa Ana, CA 92704

Preschool Lab Classrooms & New Playground

Summary Status

Description	Budgeted	Committed	Expended
Site Cost	-	-	-
Soft Cost	318,081	237,506	131,847
Hard Cost	1,398,000	1,398,000	307,461
Contingency	165,484	-	-
Total	1,881,565	1,635,506	439,308
Budgeted Hard Cost 74%			

Budget Status

Initial Amount	1,881,565
Pending Changes	-
Total	1,881,565
Budgeted Contingency 9%	

Committed Status

Initial Contracted AMT	1,635,506
Total	1,635,506
Budget Committed 87%	

Expenditure Status

Paid	124,990
In Process for PMT	314,318
Total	439,308
Budget Expended 23%	

Progress

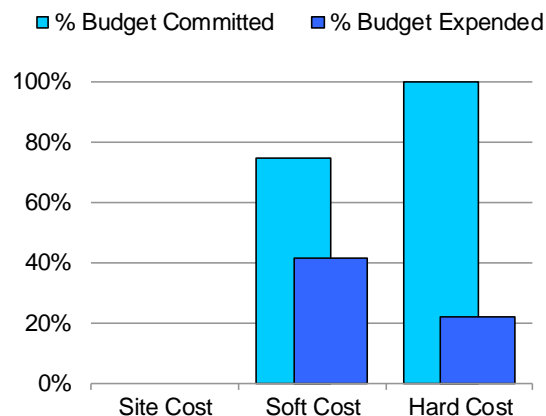

Funding Sources

Budgeted

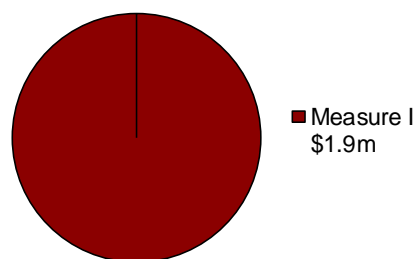



Garfield Elementary School

850 Brown St. Santa Ana, CA 92701

Modernization

Project Description

Garfield Elementary School was originally built in 1989. The site has 35 classrooms. Modernization consists of infrastructure upgrades, library and tech room improvements, office safety enhancements, and Americans with Disabilities Act (ADA) access improvements.

Architect:	Morrissey Associates, Inc.
Construction Manager:	Tilden Coil Constructors, Inc.
DSA Status:	Approved
Project Status:	Construction began May 2020
Measure I Budget:	\$7,669,956
Total Budget:	\$8,247,469

Status Summary

The project was State approved in early 2019 and is currently pending State matching funds. Construction began on Monday, May 20, 2020. The contractors had a successful start. They began with the demolition of the lunch shelter, then proceeded with the administration and two-story classroom building. The project will be complete by December 18, 2020.



Garfield Elementary School

850 Brown St. Santa Ana, CA 92701

Modernization





Garfield Elementary School

850 Brown St. Santa Ana, CA 92701

Modernization

Summary Status

Description	Budgeted	Committed	Expended
Site Cost	-	-	-
Soft Cost	1,692,414	1,539,488	616,230
Hard Cost	6,500,000	5,658,202	467,557
Contingency	55,055	-	-
Total	8,247,469	7,197,690	1,083,787
Budgeted Hard Cost 79%			

Budget Status

Initial Amount	8,247,469
Pending Changes	-
Total	8,247,469
Budgeted Contingency 1%	

Committed Status

Initial Contracted AMT	7,026,687
Contract Changes	171,003 2%
Total	7,197,690
Budget Committed 87%	

Expenditure Status

Paid	524,802
In Process for PMT	539,198
District Held Retentions	19,787
Total	1,083,787
Budget Expended 13%	

Progress

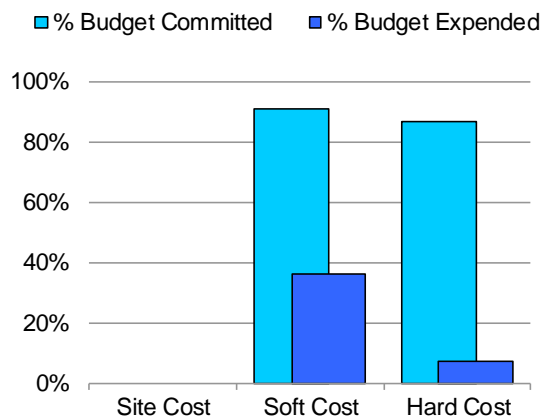

Funding Sources

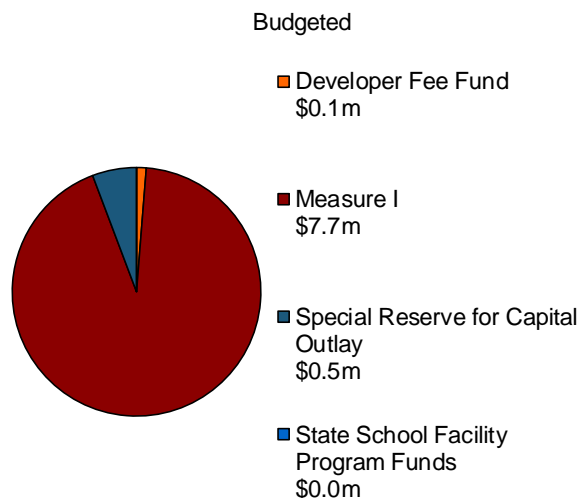



Saddleback High School

2802 S. Flower St. Santa Ana, CA 92707

New Kitchen/Indoor Dining & Interim Kitchen

Project Description

The New Kitchen, Indoor Dining and Interim Kitchen project provides an adequately sized kitchen to meet current District standards and offers an improved menu. This project converts the old kitchen into a new indoor student dining and event space. An interim kitchen will be used during construction.

Architect:	Ruhnau Clark Architects
Construction Manager:	Bernards
DSA Status:	Approved
Project Status:	New Kitchen construction began on March 12, 2020
Measure I Budget:	\$5,211,505
Total Budget:	\$13,011,505

Status Summary

The Interim Kitchen was completed on December 31, 2019, and is currently in the DSA closeout phase.

The New Kitchen Building and Indoor Dining Area are currently 25% complete. Exterior walkways and rough utilities are currently being installed. Modernization of the Interior Dining Area is currently underway. Project is scheduled to be completed by June 8, 2021.



Saddleback High School

2802 S. Flower St. Santa Ana, CA 92707

New Kitchen/Indoor Dining & Interim Kitchen





Saddleback High School

2802 S. Flower St. Santa Ana, CA 92707

New Kitchen/Indoor Dining & Interim Kitchen

Summary Status

Description	Budgeted	Committed	Expended
Site Cost	-	-	-
Soft Cost	3,299,245	3,076,043	1,601,010
Hard Cost	9,517,582	9,517,582	2,361,344
Contingency	194,678	-	-
Total	13,011,505	12,593,625	3,962,354
Budgeted Hard Cost 73%			

Budget Status

Initial Amount	13,011,505
Pending Changes	-
Total	13,011,505
Budgeted Contingency 1%	

Committed Status

Initial Contracted AMT	12,328,960
Contract Changes	264,665 2%
Total	12,593,625
Budget Committed 97%	

Expenditure Status

Paid	3,067,444
In Process for PMT	852,520
District Held Retentions	42,390
Total	3,962,354
Budget Expended 30%	

Progress

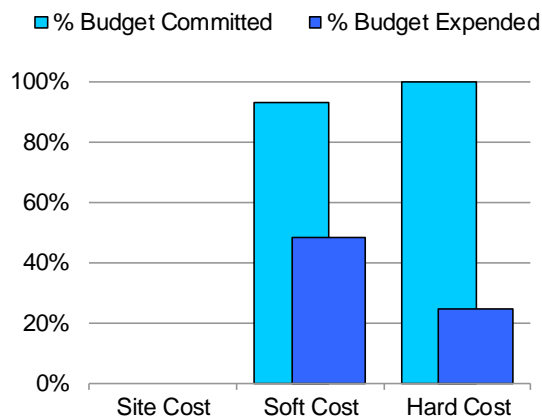

Funding Sources

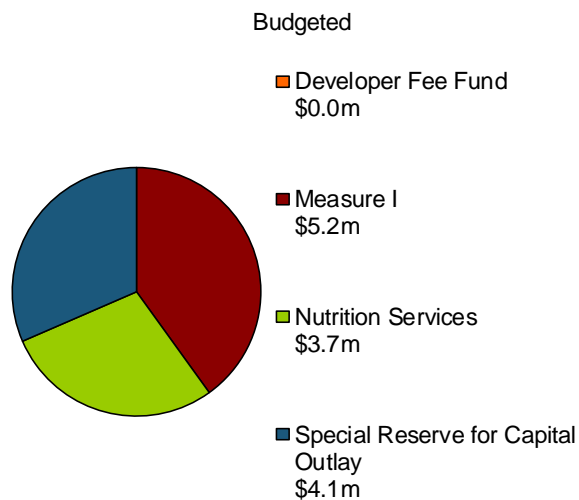



King Elementary School

1001 S. Graham Ln. Santa Ana, CA 92703

Modernization

Project Description

King Elementary School was originally built in 1991. The site has 39 classrooms. Modernization consists of infrastructure upgrades, library and tech room improvements, office safety, enhancements, and Americans with Disabilities Act (ADA) access improvements.

Architect:	Morrissey Associates, Inc.
Construction Manager:	Tilden Coil Constructors, Inc.
DSA Status:	Approved
Project Status:	Construction to begin January 2021
Measure I Budget:	\$6,592,852
Total Budget:	\$7,188,862

Status Summary

The project was State approved in early 2019 and is currently pending State matching funds. Like the Garfield modernization starting in June 2020, the King project will utilize interim housing at another location during construction. The District is currently finalizing the contract agreements. Construction will begin on January 1, 2021.



King Elementary School

1001 S. Graham Ln. Santa Ana, CA 92703

Modernization

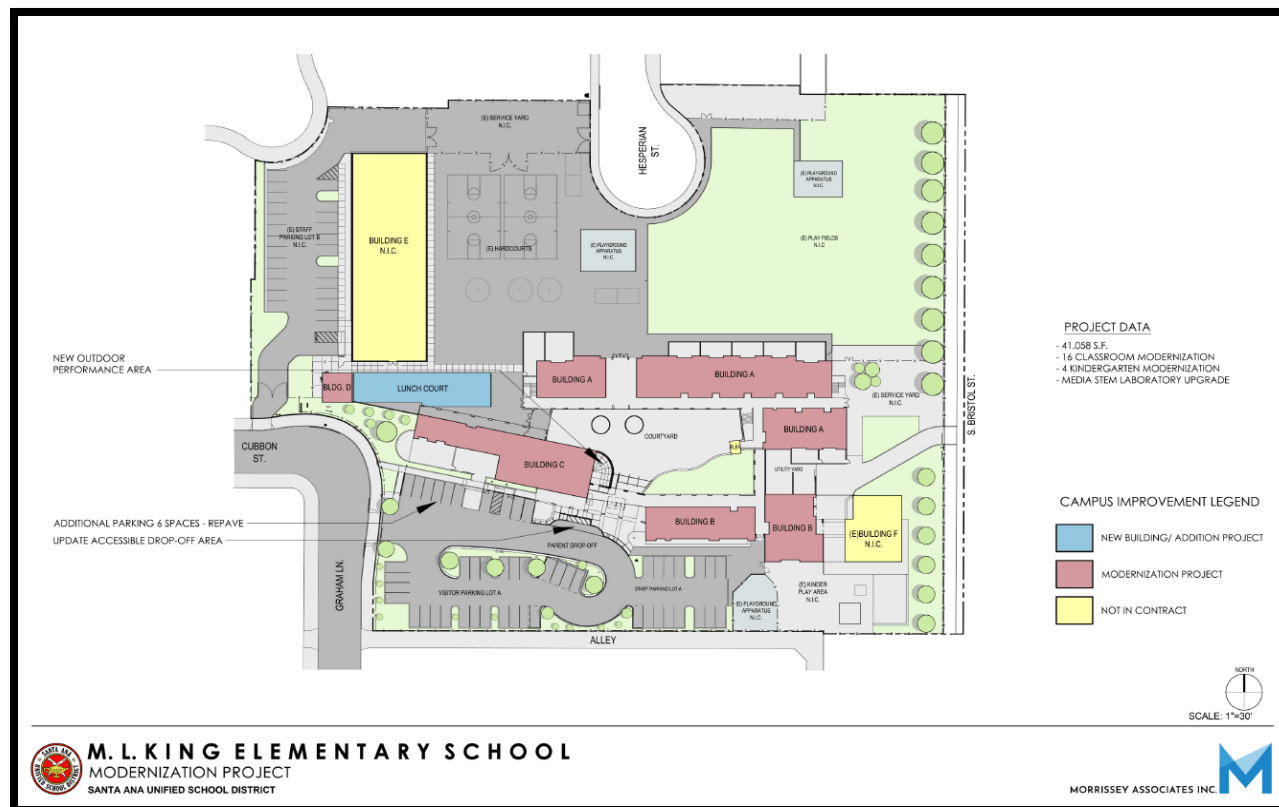



King Elementary School

1001 S. Graham Ln. Santa Ana, CA 92703

Modernization

Summary Status

Description	Budgeted	Committed	Expended
Site Cost	-	-	-
Soft Cost	1,254,075	803,348	524,769
Hard Cost	5,500,000	-	-
Contingency	434,787	-	-
Total	7,188,862	803,348	524,769
Budgeted Hard Cost 77%			

Budget Status

Initial Amount	7,188,862
Pending Changes	-
Total	7,188,862
Budgeted Contingency 6%	

Committed Status

Initial Contracted AMT	602,148
Contract Changes	201,200 25%
Total	803,348
Budget Committed 11%	

Expenditure Status

Paid	521,659
District Held Retentions	3,110
Total	524,769
Budget Expended 7%	

Progress

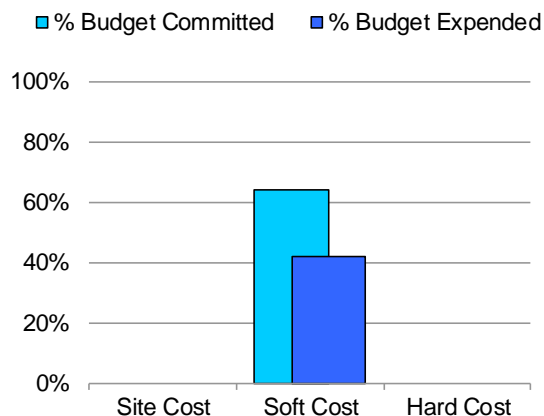

Funding Sources

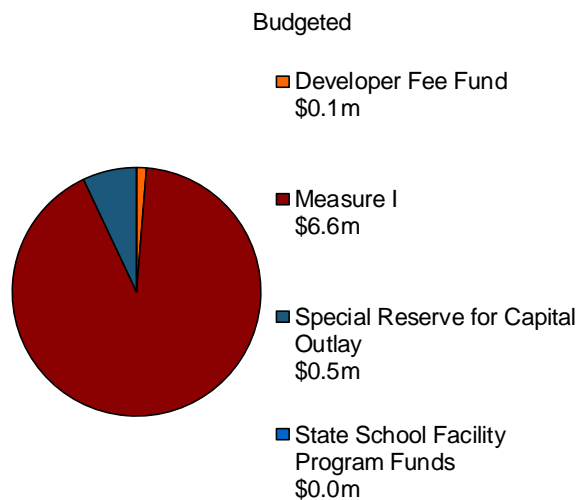



District Wide

Various sites

Marquee Installations

Phase I

Project Description

Electronic message board installations will be designed and installed at the following sites: Carver Elementary, Hoover Elementary, King Elementary, Jackson Elementary, Madison Elementary, Washington Elementary, Carr Intermediate, Villa Fundamental Intermediate, Advanced Learning Academy - Early College Program, and Chavez High School.

Architect:	Lionakis Architecture
DSA Status:	Approved
Project Status:	Bidding
Measure I Budget:	\$1,000,000
Project Budget:	\$1,000,000

Status Summary

Installation of the Carver Marquee is complete. The bidding for the four remaining marquees came back over budget and will be re-bid. Staff has been working to find an alternative bid method using the California Uniform Public Construction Cost Accounting Act (CUPCCAA) for the next sites. The four sites are: King, Madison, ALA II, and Chavez. Construction and installation are anticipated during the fall of 2020.



District Wide

Various sites

Marquee Installations

CARVER ELEMENTARY



HOOVER ELEMENTARY



JACKSON ELEMENTARY



MADISON ELEMENTARY

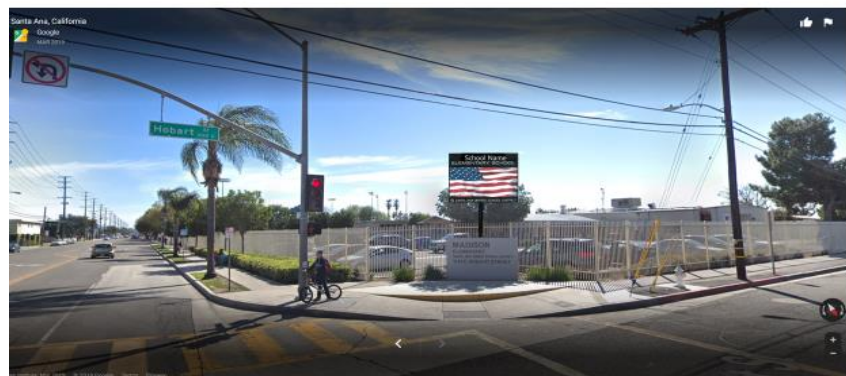



District Wide

Various sites

Marquee Installations

Summary Status

Description	Budgeted	Committed	Expended
Site Cost	-	-	-
Soft Cost	178,600	115,346	93,796
Hard Cost	735,000	31,355	31,355
Contingency	86,400	-	-
Total	1,000,000	146,701	125,151
Budgeted Hard Cost 74%			

Budget Status

Initial Amount	1,000,000
Pending Changes	-
Total	1,000,000
Budgeted Contingency 9%	

Committed Status

Initial Contracted AMT	141,180
Contract Changes	5,521 4%
Total	146,701
Budget Committed 15%	

Expenditure Status

Paid	123,501
In Process for PMT	1,650
Total	125,151
Budget Expended 13%	

Progress

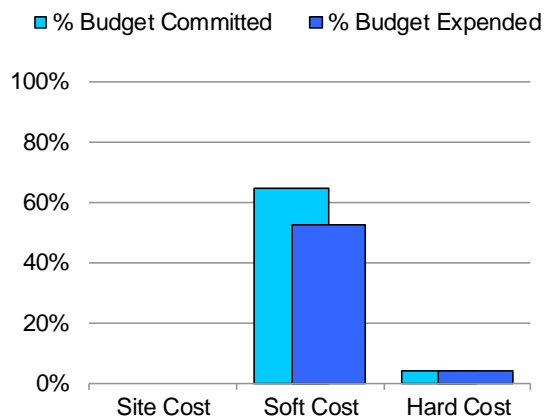

Funding Sources

Budgeted

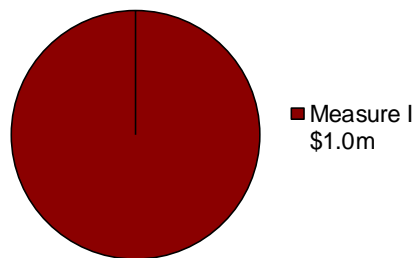



District Wide

Various sites

Single Point of Entry (SPOE)/ Fencing/ Security Cameras

Project Description

In March 2018, Facilities Planning, with input from SAUSD Police, published the District's Safety and Security Report and Plan of Action. The project includes safety upgrades at 21 schools to establish a secure Single Point of Entry, fencing gap closure, and additional security camera and lighting.

Architect:	Morrissey Associates, Inc.
DSA Status:	Pending
Project Status:	Design/Planning
Measure I Budget:	\$ 622,000 (Phase I); \$13,857,344 (Phase II, III, IV)
Total Budget:	\$ 1,000,000 (Phase I); \$13,857,344 (Phases II, III, IV)

Status Summary

Jefferson Elementary and Segerstrom High School are currently under construction. Both projects are scheduled to be completed in August 2020. The McFadden SPOE will begin construction with the Pre-K-8 optimization project. The plans have been submitted to DSA and construction is scheduled to begin in December 2020.



District Wide

Various sites

Single Point of Entry/ Fencing/ Security Cameras

Sample drawings:

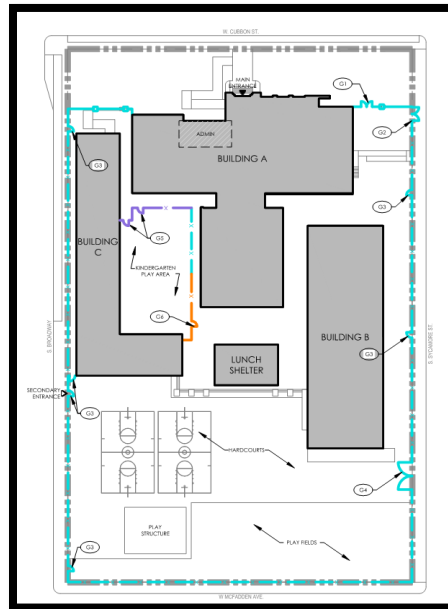

SITE FENCING
RECOMMENDATION PLAN

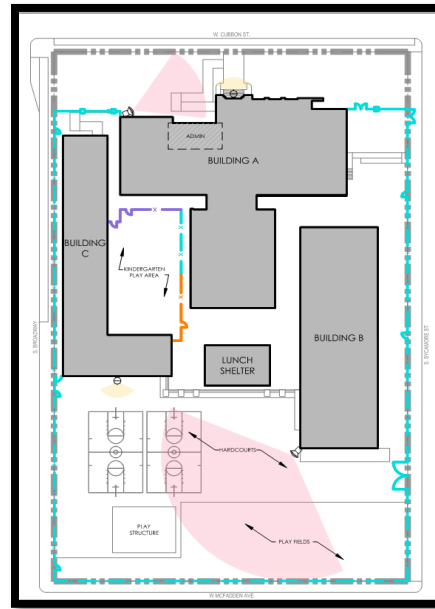

SITE LIGHTING AND CAMERA
RECOMMENDATION PLAN

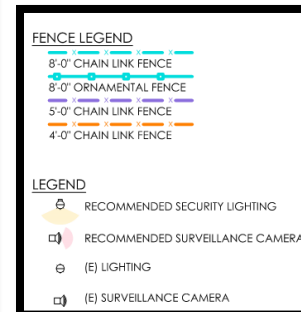

Phase I sites:

1. Carver Elementary
2. Franklin Elementary
3. Fremont Elementary
4. Garfield Elementary
5. Harvey Elementary
6. ML King Elementary
7. Pio Pico Elementary
8. Santiago K-8
9. Taft Elementary
10. Walker Elementary
11. Washington Elementary
12. Wilson Elementary
13. McFadden Intermediate
14. Romero-Cruz Academy
15. Chavez High
16. Century High
17. Godinez High
18. Saddleback High
19. Santa Ana High
20. Segerstrom High
21. Advanced Learning Academy I

* Sites listed in alphabetical order



District Wide

Various sites

Single Point of Entry/ Fencing/ Security Cameras (Phase I)

Summary Status

Description	Budgeted	Committed	Expended
Site Cost	-	-	-
Soft Cost	592,607	545,847	381,727
Hard Cost	380,000	3,190	3,190
Contingency	27,393	-	-
Total	1,000,000	549,037	384,917
Budgeted Hard Cost 38%			

Budget Status

Initial Amount	1,000,000
Pending Changes	-
Total	1,000,000
Budgeted Contingency 3%	

Committed Status

Initial Contracted AMT	372,702	
Contract Changes	176,335	32%
Total	549,037	
Budget Committed 55%		

Expenditure Status

Paid	315,972
In Process for PMT	68,946
Total	384,917
Budget Expended 38%	

Progress

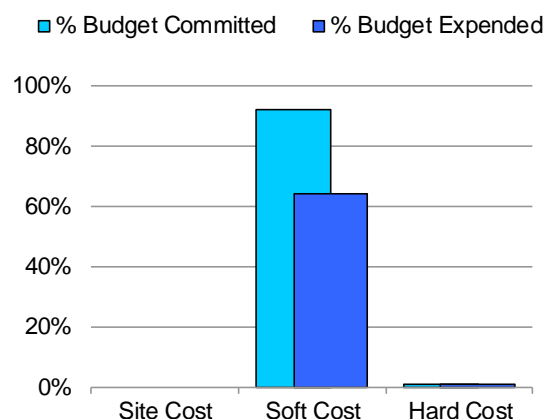

Funding Sources

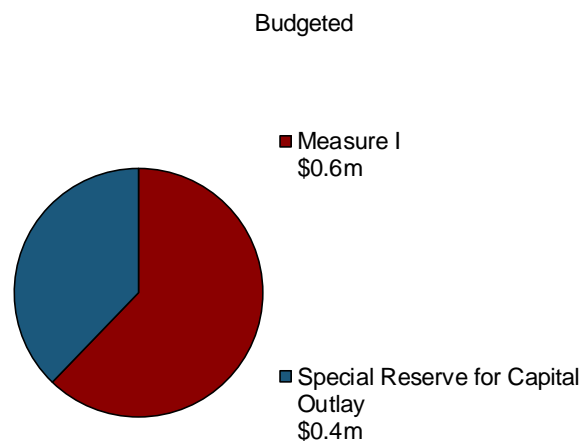



District Wide

Various sites

Single Point of Entry/ Fencing/ Security Cameras (Phases II, III, IV)

Summary Status

Description	Budgeted	Committed	Expended
Site Cost	-	-	-
Soft Cost	2,565,000	-	-
Hard Cost	10,240,000	-	-
Contingency	1,052,344	-	-
Total	13,857,344	-	-
Budgeted Hard Cost 74%			

Budget Status

Initial Amount	13,857,344
Pending Changes	-
Total	13,857,344
Budgeted Contingency 8%	

Committed Status

No Commitments to report.

Expended Status

No Expenditures to report.

Progress

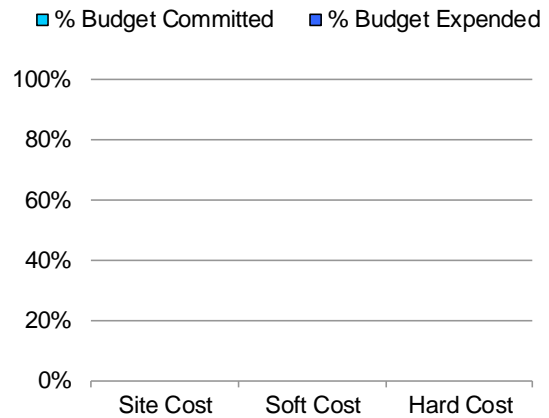

Funding Sources

Budgeted

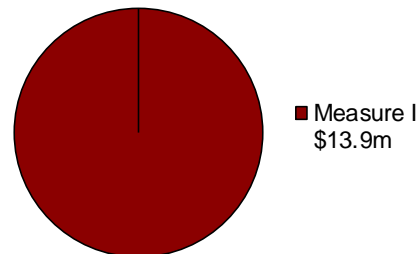



Washington Elementary School

910 W. Anahurst Pl. Santa Ana, CA 92707

Reconstruction/ Renovation

Project Description

Portions of Washington Elementary School were built over 70 years ago in 1949. This project will reorient the campus by centralizing school buildings adjacent to the P2P building by constructing a new administration, multipurpose room, kindergarten wing, new parking lot/drop-off, expand playfields, and new playgrounds as well as repurpose the original wings for Early Childhood Education (preschool) classrooms and a wellness center for community use.

Architect:	LPA and MAI
Construction Manager:	Tilden Coil
DSA Status:	N/A
Project Status:	Planning/Design
Measure I Budget:	\$18,466,788 (Reconstruction); \$6,216,958 (Renovation of original building)
Project Budget:	\$23,658,280 (Reconstruction); \$6,216,958 (Renovation of original building)

Status Summary

A modernization plan is complete. An architectural proposal for reconstruction was approved by the Board on November 19, 2019. Programming meetings with site representatives are being held to discuss conceptual design of campus improvements.



Washington Elementary School

910 W. Anahurst Pl. Santa Ana, CA 92707

Reconstruction/ Renovation

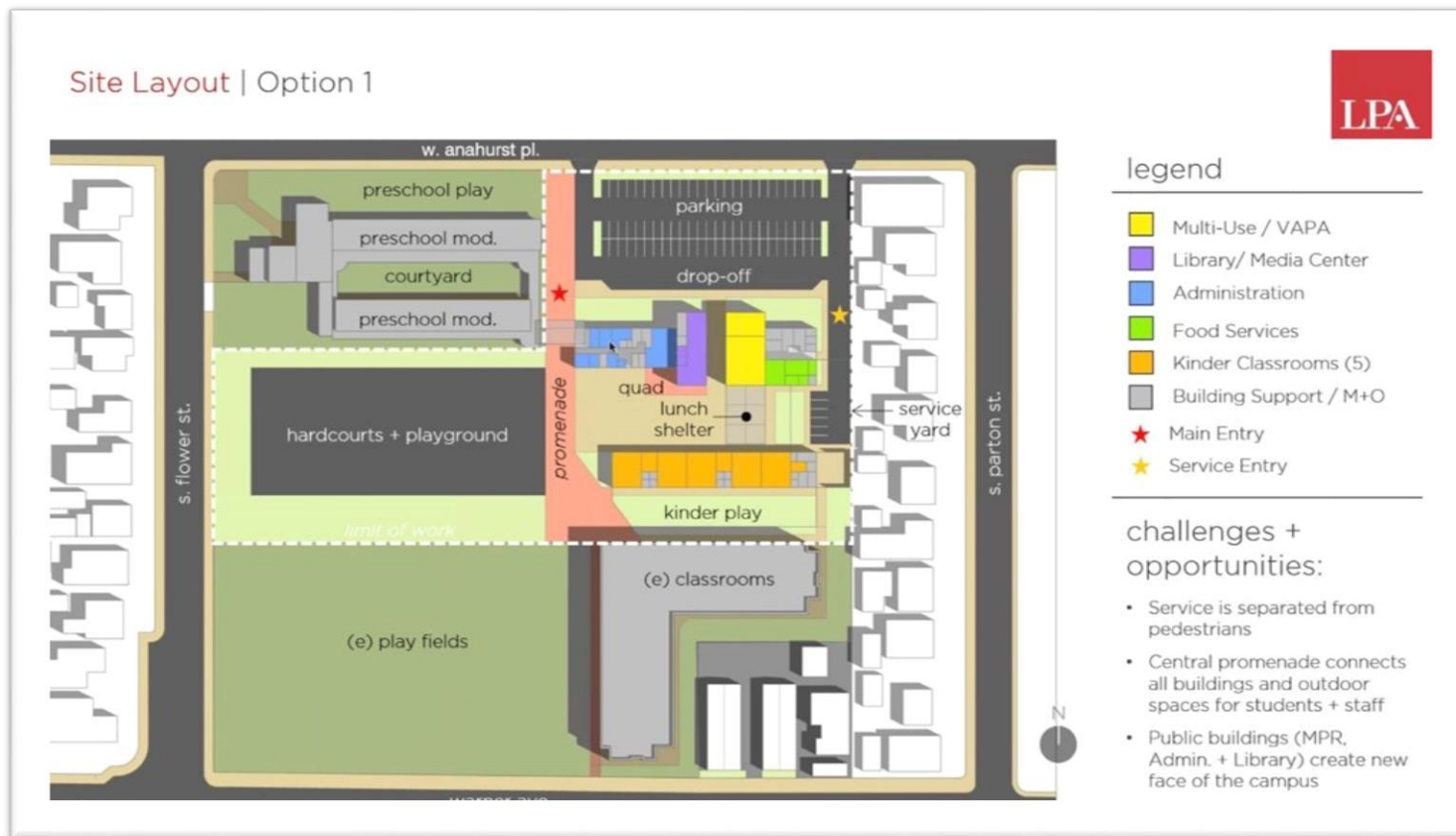



Washington Elementary School

910 W. Anahurst Pl. Santa Ana, CA 92707

Reconstruction

Summary Status

Description	Budgeted	Committed	Expended
Site Cost	-	-	-
Soft Cost	5,781,725	2,969,533	813,198
Hard Cost	16,550,000	-	-
Contingency	1,326,555	-	-
Total	23,658,280	2,969,533	813,198
Budgeted Hard Cost 70%			

Budget Status

Initial Amount	23,658,280
Pending Changes	-
Total	23,658,280
Budgeted Contingency 6%	

Committed Status

Initial Contracted AMT	2,471,672	
Contract Changes	497,861	17%
Total	2,969,533	
Budget Committed 13%		

Expenditure Status

Paid	786,214
In Process for PMT	23,075
District Held Retentions	3,909
Total	813,198
Budget Expended 3%	

Progress

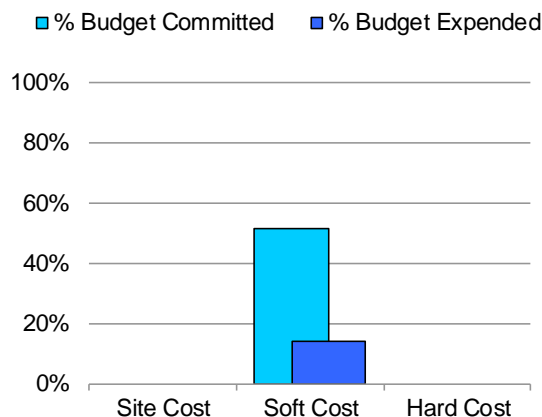

Funding Sources

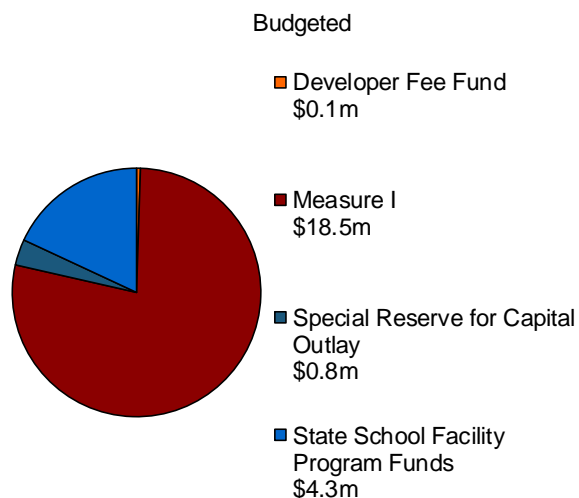



Washington Elementary School

910 W. Anahurst Pl. Santa Ana, CA 92707

Renovation

Summary Status

Description	Budgeted	Committed	Expended
Site Cost	-	-	-
Soft Cost	1,030,461	-	-
Hard Cost	4,243,074	-	-
Contingency	943,423	-	-
Total	6,216,958	-	-
Budgeted Hard Cost 68%			

Budget Status

Initial Amount	6,216,958
Pending Changes	-
Total	6,216,958
Budgeted Contingency 15%	

Committed Status

No Commitments to report.

Expended Status

No Expenditures to report.

Progress

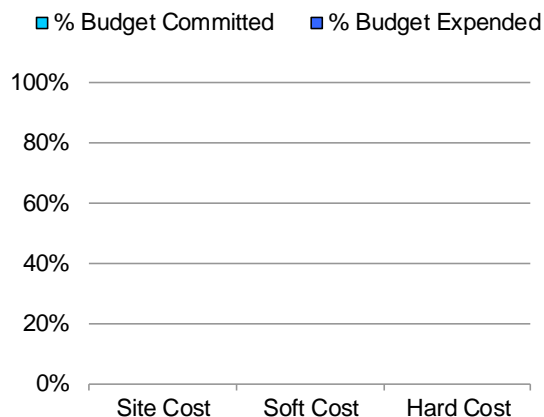

Funding Sources

Budgeted

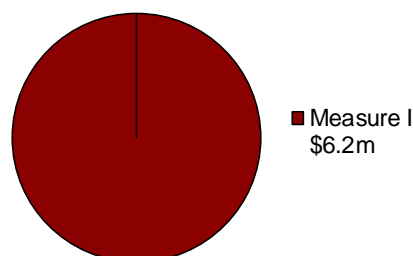



Saddleback High School

2802 S. Flower St. Santa Ana, CA 92707

Sports Complex

Project Description

Saddleback High School was built in 1966 without sports facilities equitable to other comprehensive high schools. This project establishes a stadium and support buildings for school and community use.

Architect:	LPA
Construction Manager:	Bernards
DSA Status:	Pending Submittal
Project Status:	Planning
Measure I Budget:	\$17,994,090
Project Budget:	\$18,994,090

Status Summary

In 2019, District and site staff began planning based on the 2018 Facilities Master Plan. On September 21, 2019, an informational meeting was held with parents and community members to gather feedback on the proposed approach. On December 12, 2019, parents and staff from Saddleback toured a comparable facility at University High School in Irvine. Architect and Construction Manager Contracts were approved by the Board, and programming meetings with site representatives are being held to discuss conceptual design.



Saddleback High School

2802 S. Flower St. Santa Ana, CA 92707

Sports Complex





Saddleback High School

2802 S. Flower St. Santa Ana, CA 92707

Sports Complex

Summary Status

Description	Budgeted	Committed	Expended
Site Cost	-	-	-
Soft Cost	3,800,774	-	-
Hard Cost	13,180,662	-	-
Contingency	2,012,654	-	-
Total	18,994,090	-	-
Budgeted Hard Cost 69%			

Budget Status

Initial Amount	18,994,090
Pending Changes	-
Total	18,994,090
Budgeted Contingency 11%	

Committed Status

No Commitments to report.

Expended Status

No Expenditures to report.

Progress

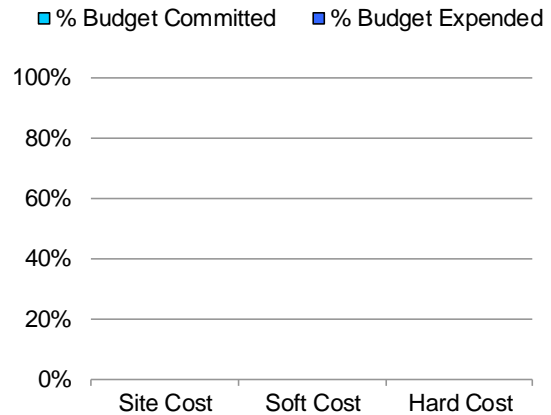

Funding Sources

Budgeted

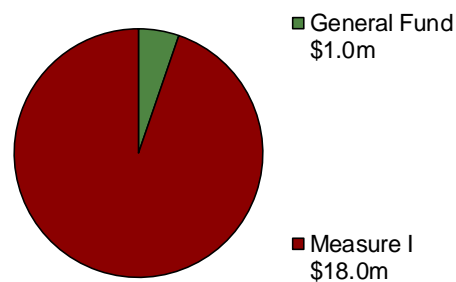



Valley High School

1801 S. Greenville St. Santa Ana, CA 92704

CTE Culinary Arts Building

Project Description

This project will provide an innovative and agile learning space to increase the capacity of the Culinary Arts & Hospitality Academy (CHA) and construct a modern space for food preparation, instruction and serving.

Architect:	Baker Nowicki
Construction Manager:	Tilden Coil
DSA Status:	Pending Submittal
Project Status:	Design/Planning
Measure I Budget:	\$3,000,000
Total Budget:	\$6,000,000

Status Summary

In fall 2018, staff prepared an application for the State's Career Technical Education Facilities Grant Program. The grant received a high score and was ultimately funded by the State in May 2020, which provides a \$3,000,000 to the District. A conceptual master site planning study was completed in January 2020 and an architectural proposal for design/engineering was approved. Staff has completed the interior programming with student, campus, and community participation. Plans are scheduled for DSA submittal in December of 2020.



Valley High School

1801 S. Greenville St. Santa Ana, CA 92704

CTE Culinary Arts Building

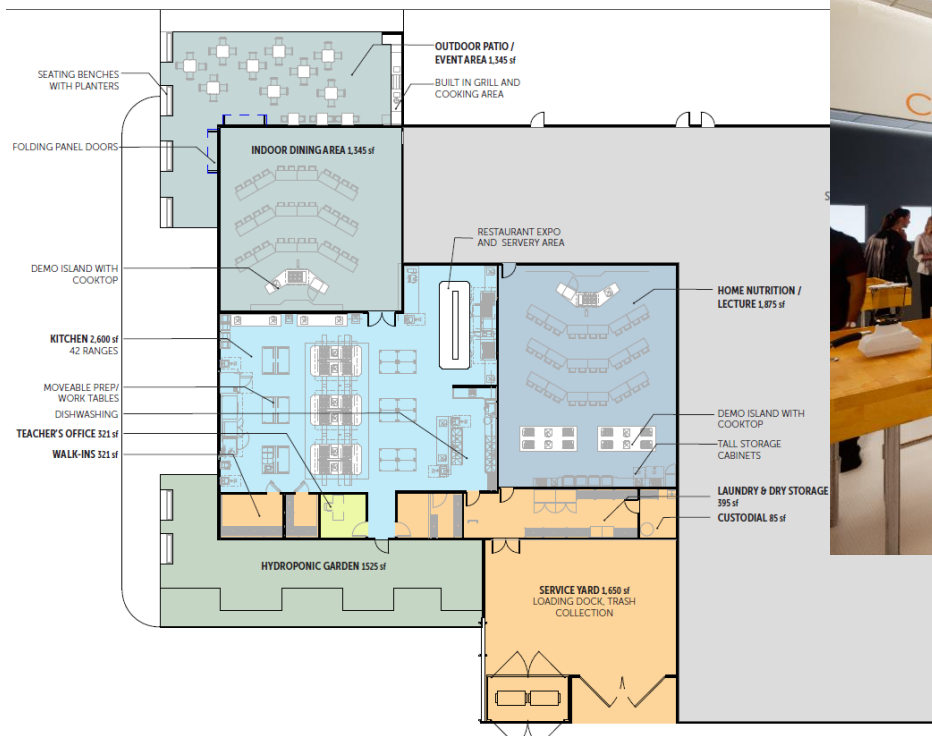



Valley High School

1801 S. Greenville St. Santa Ana, CA 92704

CTE Culinary Arts Building

Summary Status

Description	Budgeted	Committed	Expended
Site Cost	-	-	-
Soft Cost	1,316,148	754,897	126,146
Hard Cost	4,095,000	-	-
Contingency	588,852	-	-
Total	6,000,000	754,897	126,146
Budgeted Hard Cost 68%			

Budget Status

Initial Amount	6,000,000
Pending Changes	-
Total	6,000,000
Budgeted Contingency 10%	

Committed Status

Initial Contracted AMT	754,897
Contract Changes	- 0%
Total	754,897
Budget Committed 13%	

Expenditure Status

Paid	54,575
In Process for PMT	71,571
Total	126,146
Budget Expended 2%	

Progress

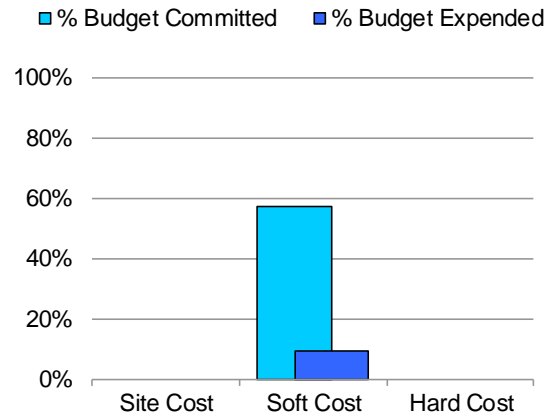

Funding Sources

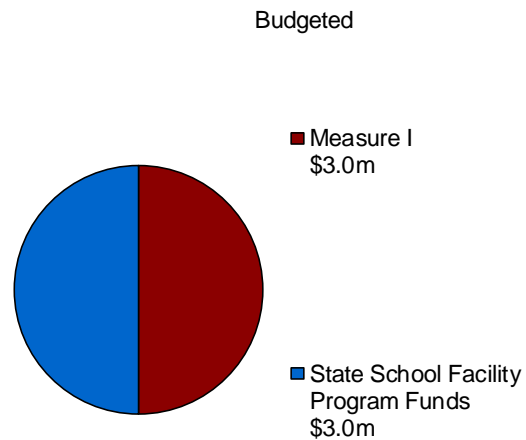



Valley High School

1801 S. Greenville St. Santa Ana, CA 92704

Auditorium Renovation

Project Description

The auditorium at Valley High School was built in 1959 and has had minimal improvements since that time. This project will provide modern interiors and attractive exteriors such as restroom replacement, rigging system and stage floor replacement, Americans with Disabilities Act (ADA) compliance, technology replacement, LED stage lighting, HVAC upgrade, seat replacement, Greenroom renovation, and site work and landscaping improvements. The completed project will provide a modern school and community resource for the performing arts.

Architect:	Baker Nowicki
Construction Manager:	Tilden Coil
DSA Status:	Pending Submittal
Project Status:	Schematic Design Phase
Measure I Budget:	\$18,537,001
Total Budget:	\$20,937,001

Status Summary

An assessment of existing conditions and initial design of improvements began in October 2019. Teachers and site staff were consulted as to needed improvements in order to refine the project's scope of work. An assessment and feasibility study was received from the architect in January 2020, and shared with the Valley Instructional Leadership Team. Meetings with student representatives and design team were held to begin the schematic design phase. The design team has suspended further planning until the DSA submittal of the Culinary/Auto building.



Valley High School

1801 S. Greenville St. Santa Ana, CA 92704

Auditorium Renovation

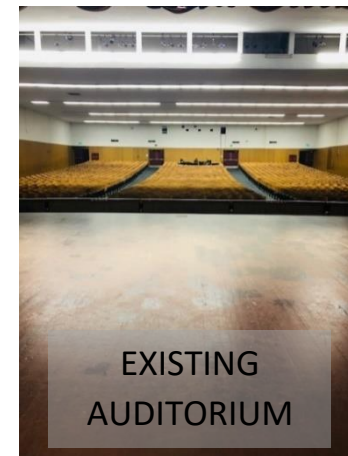
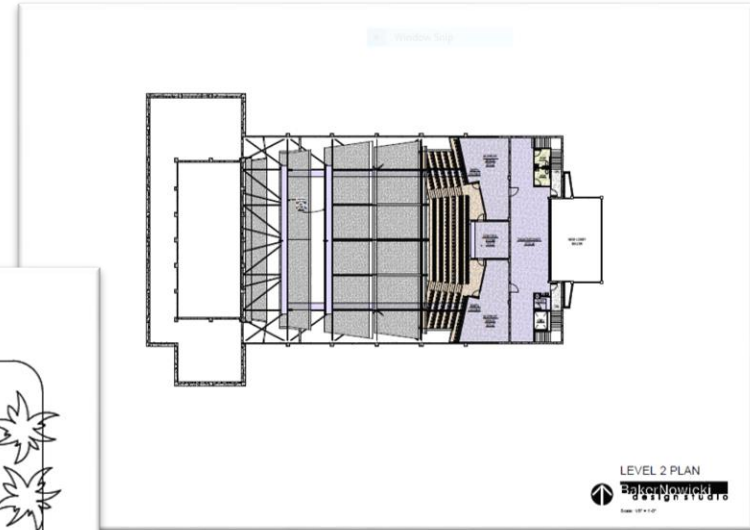
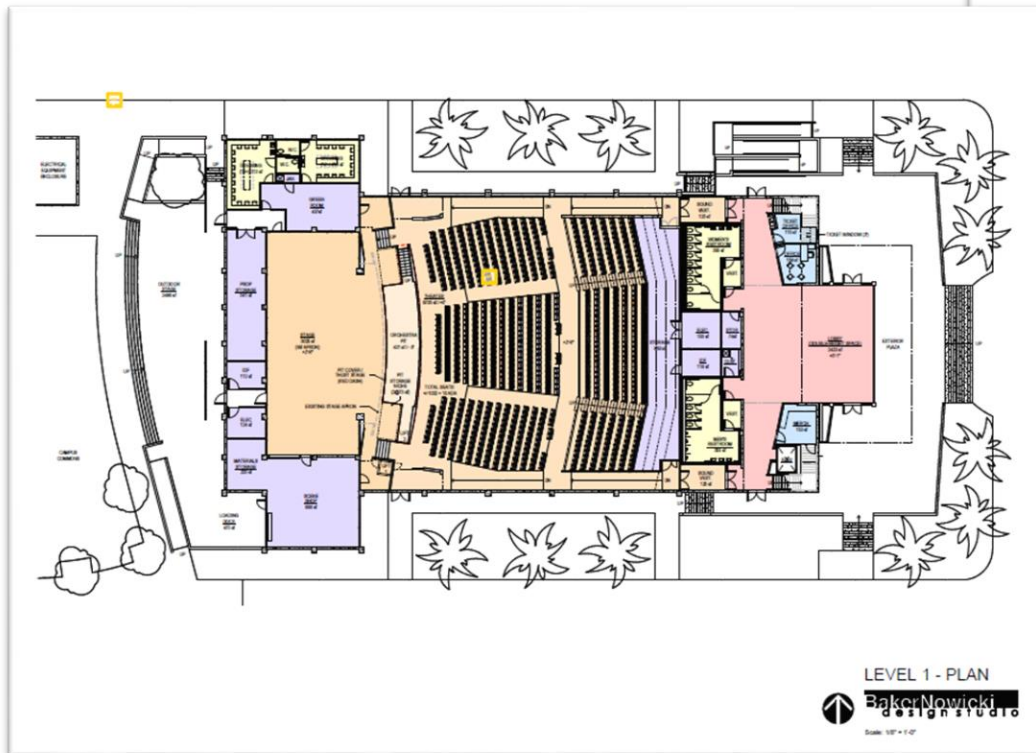



Valley High School

1801 S. Greenville St. Santa Ana, CA 92704

Auditorium Renovation

Summary Status

Description	Budgeted	Committed	Expended
Site Cost	-	-	-
Soft Cost	5,748,845	1,853,401	228,629
Hard Cost	10,500,000	-	-
Contingency	4,688,156	-	-
Total	20,937,001	1,853,401	228,629
Budgeted Hard Cost 50%			

Budget Status

Initial Amount	20,937,001
Pending Changes	-
Total	20,937,001
Budgeted Contingency 22%	

Committed Status

Initial Contracted AMT	1,853,401
Contract Changes	- 0%
Total	1,853,401
Budget Committed 9%	

Expenditure Status

Paid	88,107
In Process for PMT	140,522
Total	228,629
Budget Expended 1%	

Progress

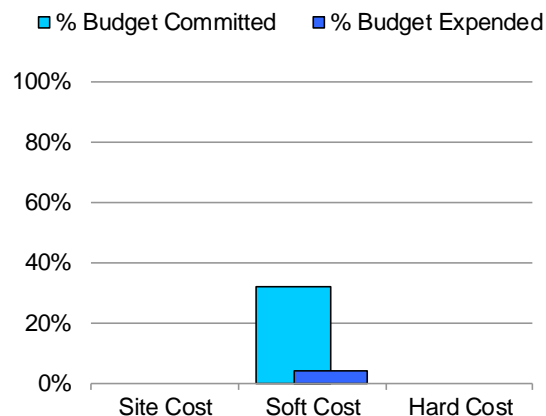

Funding Sources

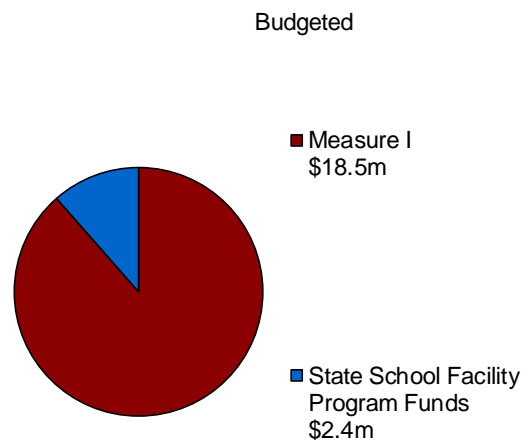



Jefferson Elementary School

1522 W. Adams St. Santa Ana, CA 92704

Portable to Permanent (P2P) and Multi-Purpose Room (MPR)

Project Description

Jefferson Elementary School was built in 1965 and contains 12 portable classrooms that have been added over the years to address capacity needs. The project vision replaces portables with a permanent 2-story building, improves parking and circulation efficiency, and adds a multipurpose room (MPR) for the school and community use.

Architect:	Morrissey Associates, Inc.
DSA Status:	Pending Submittal
Project Status:	Schematic Design Phase Underway
Measure I Budget:	\$ 24,500,000
Total Budget:	\$ 24,500,000

Status Summary

An assessment of existing conditions and initial design of improvements began in October 2019. MAI has provided an initial program for the administration space, classrooms, and MPR. Teachers and site staff have been consulted regarding improvements in order to refine the project's scope of work.

The project moved into the schematic design phase in May 2020, with an anticipated DSA submission in December 2020.



Jefferson Elementary School

1522 W. Adams St. Santa Ana, CA 92704

Portable to Permanent (P2P) and Multi-Purpose Room (MPR)

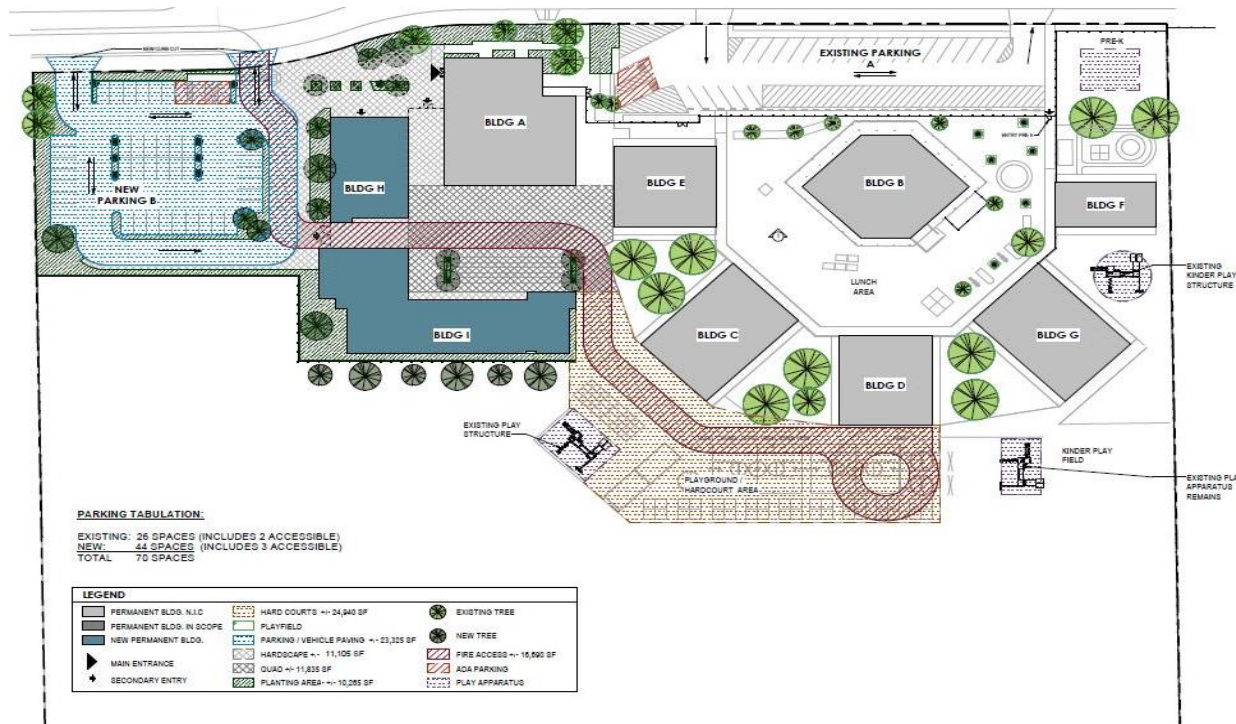



Jefferson Elementary School

1522 W. Adams St. Santa Ana, CA 92704

Portable to Permanent (P2P) and Multi-Purpose Room (MRP)

Summary Status

Description	Budgeted	Committed	Expended
Site Cost	-	-	-
Soft Cost	4,902,977	1,353,788	112,948
Hard Cost	18,000,000	-	-
Contingency	1,597,023	-	-
Total	24,500,000	1,353,788	112,948
Budgeted Hard Cost 73%			

Budget Status

Initial Amount	24,500,000
Pending Changes	-
Total	24,500,000
Budgeted Contingency 7%	

Committed Status

Initial Contracted AMT	2,082,368
Contract Changes	(728,580) -54%
Total	1,353,788
Budget Committed 6%	

Expenditure Status

Paid	93,345
In Process for PMT	19,603
Total	112,948
Budget Expended 0%	

Progress

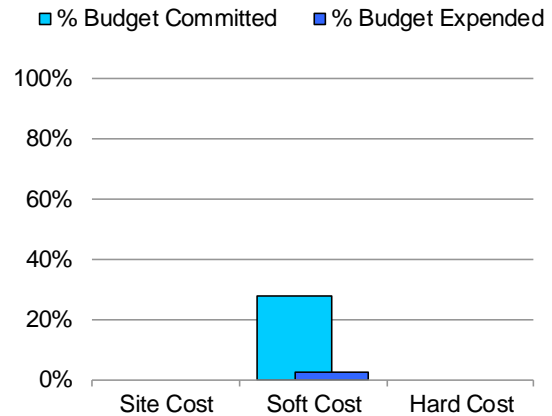

Funding Sources

Budgeted

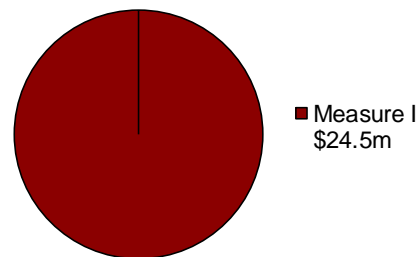



McFadden Intermediate School

2701 S. Raitt St. Santa Ana, CA 92704

Optimization – Pre-K–8 Conversion

Project Description

McFadden Intermediate School was built in 1965 and currently houses sixth through eighth grade classes. This Campus Optimization project converts McFadden Intermediate School into a Pre-Kindergarten through Eighth Grade School. The project consists of four (4) new modular kindergarten/preschool classrooms and associated play areas.

Architect:	Morrissey Associates, Inc.
Construction Manager:	Tilden Coil
DSA Status:	Submitted May 20, 2020
Project Status:	Planning
Measure I Budget:	\$8,298,448
Total Budget:	\$8,298,448

Status Summary

An assessment of existing conditions and initial design of improvements began in March 2020. The Design Team has been meeting regularly to keep the project on track. DSA plans submitted in May 2020 and comments were received on July 21, 2020. DSA approval is expected in August 2020, and construction is expected to begin in December 2020.



Mc Fadden Intermediate School

2701 S. Raitt St. Santa Ana, CA 92704

Optimization – Pre-K–8 Conversion



Site Schematic Plan
McFADDEN INTERMEDIATE SCHOOL
Portfolio Classroom Project
Santa Ana Unified School District

SCALE: 1" = 30'-0"
DATE: 01/09/2020
M
HARRISSEY





Mc Fadden Intermediate School

2701 S. Raitt St. Santa Ana, CA 92704

Optimization – Pre-K–8 Conversion

Summary Status

Description	Budgeted	Committed	Expended
Site Cost	-	-	-
Soft Cost	1,905,159	532,836	225,751
Hard Cost	5,813,691	-	-
Contingency	579,598	-	-
Total	8,298,448	532,836	225,751
Budgeted Hard Cost 70%			

Budget Status

Initial Amount	8,298,448
Pending Changes	-
Total	8,298,448
Budgeted Contingency 7%	

Committed Status

Initial Contracted AMT	532,835
Contract Changes	1 0%
Total	532,836
Budget Committed 6%	

Expenditure Status

Paid	121,967
In Process for PMT	103,784
Total	225,751
Budget Expended 3%	

Progress

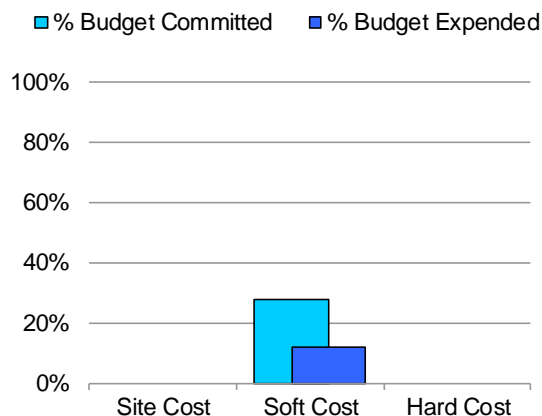

Funding Sources

Budgeted

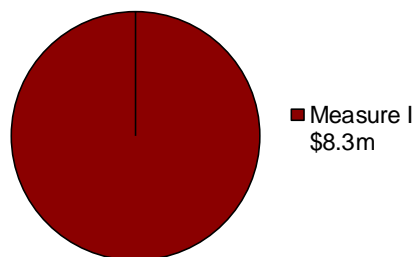



Sierra Intermediate School

2021 N. Grand Ave. Santa Ana, CA 92705

Optimization – Pre-K–8 Conversion

Project Description

Sierra Intermediate School was built in 1964 and currently houses fifth through eighth grade classes. This Campus Optimization project converts Sierra Intermediate School into a Pre-Kindergarten through Eighth Grade Elementary School. The project consists of four (4) new modular kindergarten/preschool classrooms and associated play areas.

Architect:	Morrissey Associates, Inc.
Construction Manager:	Tilden Coil
DSA Status:	Submitted May 20, 2020
Project Status:	Planning
Measure I Budget:	\$6,958,685
Total Budget:	\$6,958,685

Status Summary

An assessment of existing conditions and initial design of improvements began in March 2020. The Design Team has been meeting regularly to keep the Project on track. Plans were submitted to DSA in May 2020 and comments were received on July 21, 2020. DSA approval is expected in August 2020, and construction is expected to begin in December 2020.



2021 N. Grand Ave. Santa Ana, CA 92705



Interior Schematic Renderings





Sierra Intermediate School

2021 N. Grand Ave. Santa Ana, CA 92705

Optimization – Pre-K–8 Conversion

Summary Status

Description	Budgeted	Committed	Expended
Site Cost	-	-	-
Soft Cost	1,429,386	462,978	206,394
Hard Cost	4,749,303	-	-
Contingency	779,996	-	-
Total	6,958,685	462,978	206,394
Budgeted Hard Cost 68%			

Budget Status

Initial Amount	6,958,685
Pending Changes	-
Total	6,958,685
Budgeted Contingency 11%	

Committed Status

Initial Contracted AMT	462,978
Contract Changes	- 0%
Total	462,978
Budget Committed 7%	

Expenditure Status

Paid	109,576
In Process for PMT	94,506
District Held Retentions	2,312
Total	206,394
Budget Expended 3%	

Progress

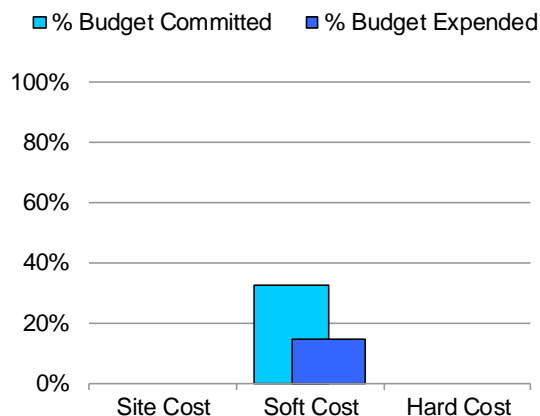

Funding Sources

Budgeted

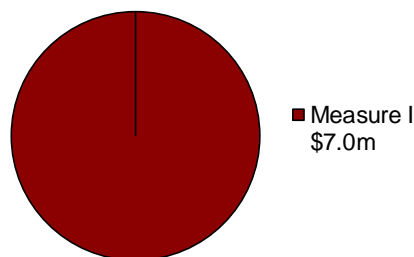



Romero-Cruz Academy and Lathrop Intermediate School

2701 W. Fifth St. Santa Ana, CA 92703; 1111 S. Broadway Santa Ana, CA 92706

Playground Improvements

Project Description

Romero-Cruz Academy K-8 School was built in 1975 and currently houses pre-kindergarten through eighth grade. Lathrop Intermediate School was built in 1974 and currently houses sixth through eighth grade. The schools previously functioned as Intermediate grade levels and did not have playground equipment for elementary. The new playground equipment will be suitable for upper grade elementary students.

Architect:	Pending
DSA Status:	Pending Submittal
Project Status:	Pending Board Approval of Architect
Measure I Budget:	\$1,473,855
Total Budget:	\$1,473,855

Status Summary

Staff is currently reviewing the proposal for architectural services for the playgrounds.



Romero-Cruz Academy and Lathrop Intermediate School

2701 W. Fifth St. Santa Ana, CA 92703; 1111 S. Broadway Santa Ana, CA 92706

Playground Improvements

Summary Status

Description	Budgeted	Committed	Expended
Site Cost	-	-	-
Soft Cost	263,500	-	-
Hard Cost	1,095,000	-	-
Contingency	115,355	-	-
Total	1,473,855	-	-
Budgeted Hard Cost 74%			

Budget Status

Initial Amount	1,473,855
Pending Changes	-
Total	1,473,855
Budgeted Contingency 8%	

Committed Status

No Commitments to report.

Expended Status

No Expenditures to report.

Progress

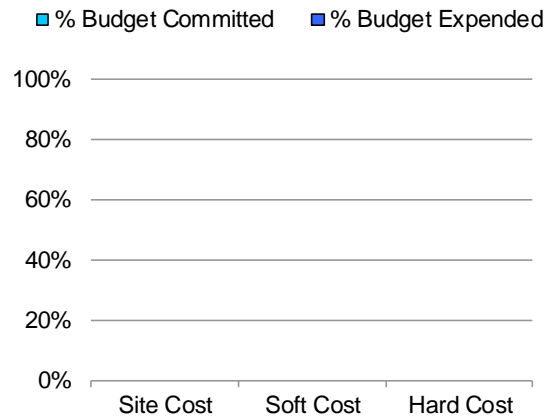

Funding Sources

Budgeted

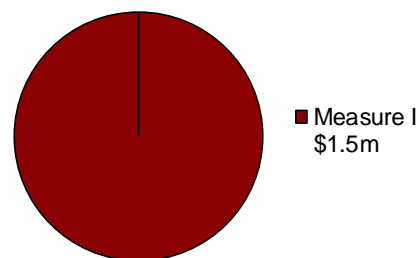



District Wide

Various Sites

Furniture Fixtures & Equipment

Project Description

Provide furniture or classroom technology in order to complete the Campus Optimization projects at Roosevelt/Walker as well as planning for the Garfield Modernization and Muir Portable to Permanent (P2P) projects.

Project Status:	In Process
Measure I Budget:	\$903,100
Total Budget:	\$903,100

Status Summary

Principals at Roosevelt, Walker, Garfield, and Muir provided feedback during the planning for Campus Optimization projects at. The Board directed staff to use bond funds to pay for the furniture and technology requested.



District Wide

Various Sites

Furniture Fixtures & Equipment





District Wide

Various Sites

Furniture Fixtures & Equipment

Summary Status

Description	Budgeted	Committed	Expended
Site Cost	-	-	-
Soft Cost	721,000	-	-
Hard Cost	100,000	-	-
Contingency	82,100	-	-
Total	903,100	-	-
Budgeted Hard Cost 11%			

Budget Status

Initial Amount	903,100
Pending Changes	-
Total	903,100
Budgeted Contingency 9%	

Committed Status

No Commitments to report.

Expended Status

No Expenditures to report.

Progress

■ % Budget Committed ■ % Budget Expended



Funding Sources

Budgeted

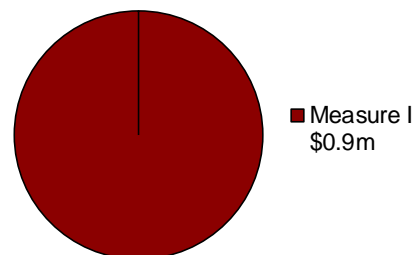



District Wide

Various Sites

Marquee Installations

Phase II

Project Description

Electronic message board installations will be designed and installed at the following sites: Franklin Elementary, Harvey Elementary, Jefferson Elementary, Lincoln Elementary, Monte Vista Elementary, Roosevelt Elementary, Taft Elementary, Walker Elementary, Wilson Elementary, Lorin Grisct Academy, REACH Academy, and Segerstrom High.

Architect:	Lionakis Architecture (proposed)
DSA Status:	Pending Submittal
Project Status:	Planning/Design
Measure I Budget	\$1,000,000
Total Budget:	\$1,000,000

Status Summary

The same architect from Phase I is proposed for Phase II, which may commence upon issuance of additional Measure I funding.



District Wide

Various Sites

Marquee Installations

Phase II

Summary Status

Description	Budgeted	Committed	Expended
Site Cost	-	-	-
Soft Cost	178,600	-	-
Hard Cost	735,000	-	-
Contingency	86,400	-	-
Total	1,000,000	-	-
Budgeted Hard Cost 74%			

Budget Status

Initial Amount	1,000,000
Pending Changes	-
Total	1,000,000
Budgeted Contingency 9%	

Committed Status

No Commitments to report.

Expended Status

No Expenditures to report.

Progress

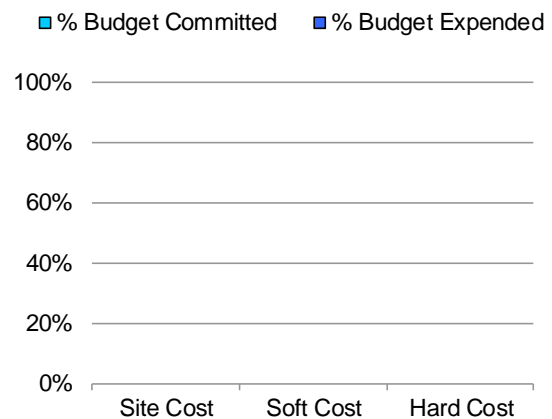

Funding Sources

Budgeted

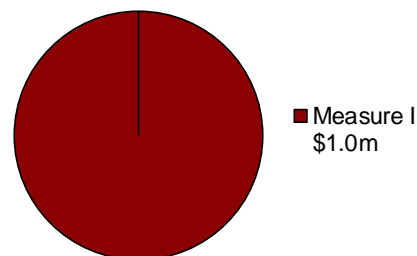



Century High School

1401 S. Grand Ave., Santa Ana, CA 92705

Modernization

Project Description

Century High School was originally built in 1989. The planned Modernization project provides general renovation of the school's facilities, including a modern library, maker space, Americans with Disabilities Act (ADA) accessible restrooms, kitchen improvements, and a new office and counseling center.

Architect:	HMC Architects
Construction Manager:	Ledesma & Meyer Construction Co., Inc.
DSA Status:	Approved
Project Status:	Pending State Bond Funds
Measure I Budget:	\$5,849,163
Total Budget:	\$19,771,429

Status Summary

The project was State approved in late 2018 and is currently pending State matching funds. Once funds are announced, the District will begin bidding and preparation for construction.



Century High School

1401 S. Grand Ave., Santa Ana, CA 92705

Modernization

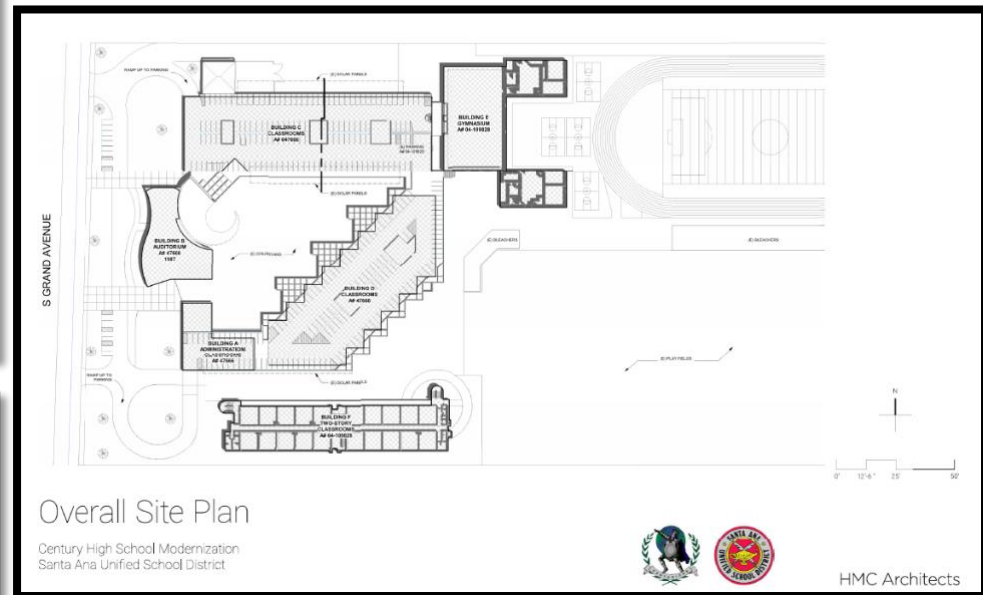
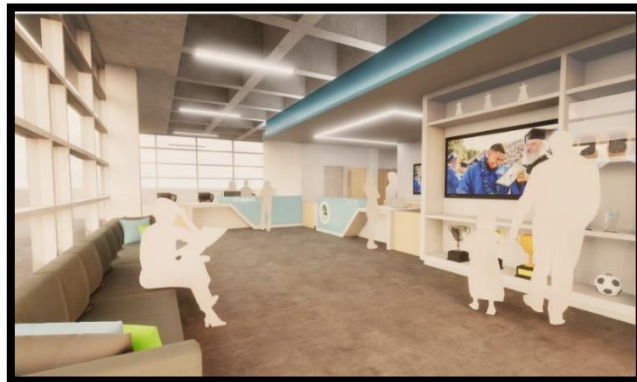



Century High School

1401 S. Grand Ave., Santa Ana, CA 92705

Modernization

Summary Status

Description	Budgeted	Committed	Expended
Site Cost	-	-	-
Soft Cost	4,241,768	2,059,409	1,533,062
Hard Cost	13,322,322	-	-
Contingency	2,207,340	-	-
Total	19,771,429	2,059,409	1,533,062
Budgeted Hard Cost 67%			

Budget Status

Initial Amount	19,771,429
Pending Changes	-
Total	19,771,429
Budgeted Contingency 11%	

Committed Status

Initial Contracted AMT	1,060,450
Contract Changes	998,959 49%
Total	2,059,409
Budget Committed 10%	

Expenditure Status

Paid	1,533,062
Total	1,533,062
Budget Expended 8%	

Progress

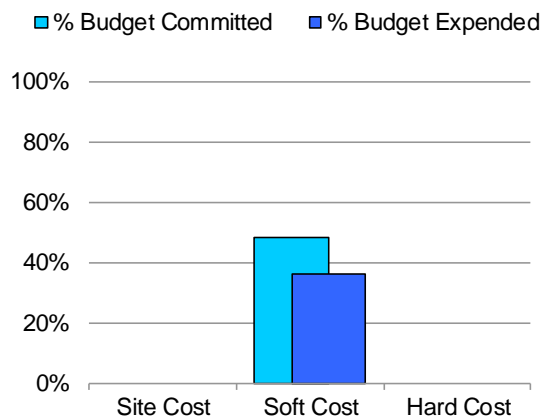

Funding Sources

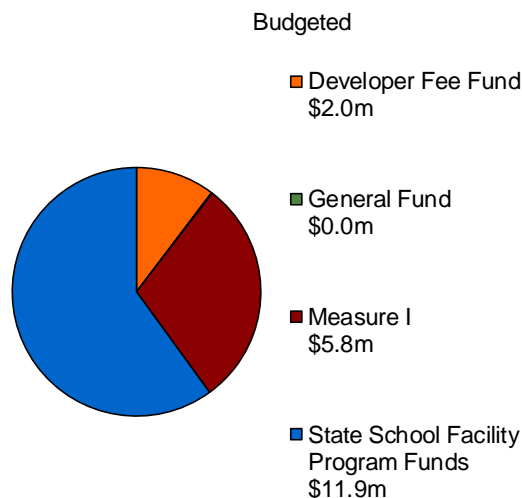



Santa Ana High School

520 W. Walnut St. Santa Ana, CA 92701

Modernization

Project Description

Santa Ana High School was originally built in 1935. The project provides general modernization of the school's facilities, including a new attendance office and secure campus entry, new dance and music classrooms, new ADA accessible restrooms, and a new health office and wellness center.

Architect:	HMC Architects
Construction Manager:	Ledesma & Meyer Construction Co., Inc.
DSA Status:	Approved
Bidding & Award:	Pending State Bond Funds
Measure I Budget	\$6,259,505
Project Budget:	\$21,000,000

Status Summary

The project was State approved in late 2018 and is currently pending State matching funds. Once funds are allocated by the State Allocation Board, the District will begin bidding and preparation for construction.



Santa Ana High School

520 W. Walnut St. Santa Ana, CA 92701

Modernization

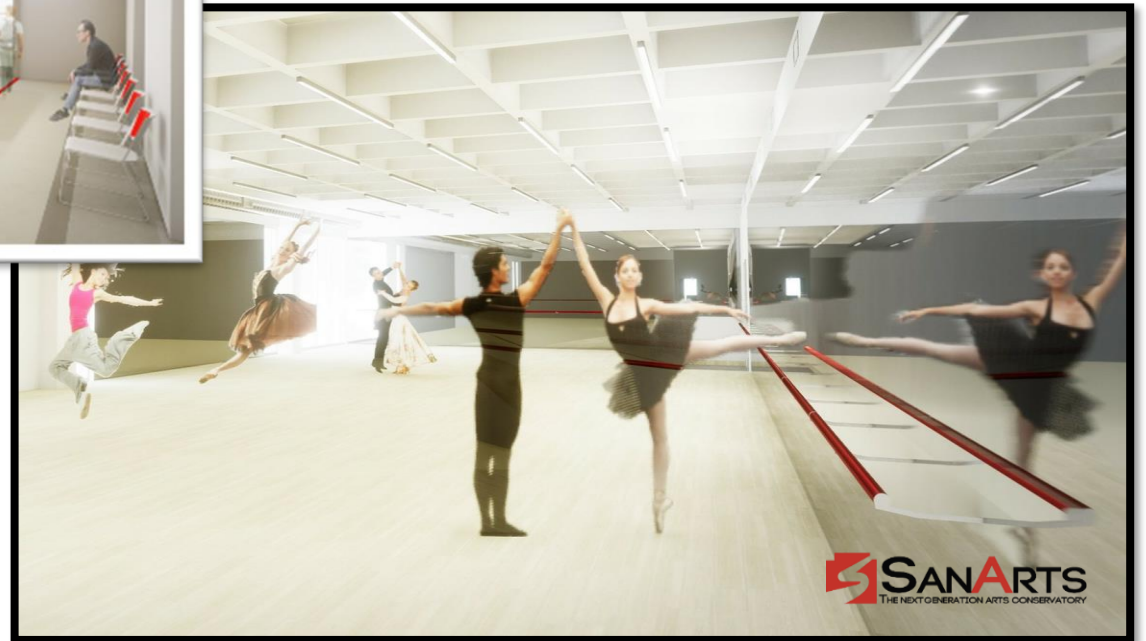



Santa Ana High School

520 W. Walnut St. Santa Ana, CA 92701

Modernization

Summary Status

Description	Budgeted	Committed	Expended
Site Cost	-	-	-
Soft Cost	3,969,880	2,140,495	1,573,167
Hard Cost	16,374,458	-	-
Contingency	655,662	-	-
Total	21,000,000	2,140,495	1,573,167
Budgeted Hard Cost 78%			

Budget Status

Initial Amount	21,000,000
Pending Changes	-
Total	21,000,000
Budgeted Contingency 3%	

Committed Status

Initial Contracted AMT	690,745
Contract Changes	1,449,750 68%
Total	2,140,495
Budget Committed 10%	

Expenditure Status

Paid	1,573,167
Total	1,573,167
Budget Expended 7%	

Progress

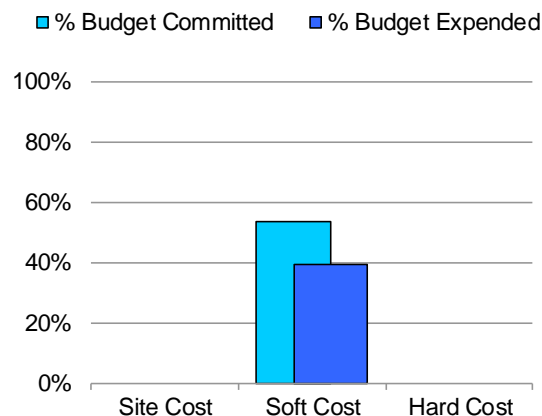

Funding Sources

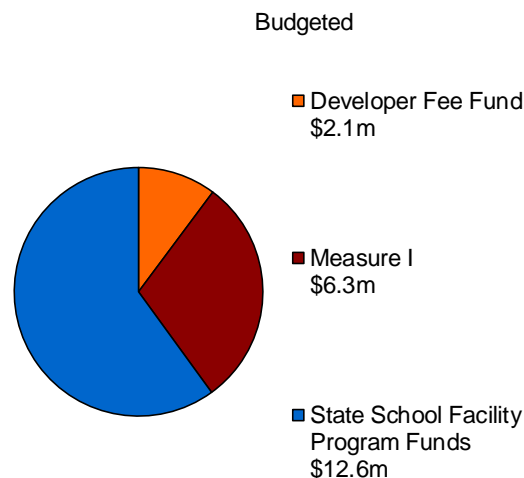



Chavez High School

2128 S. Cypress Ave., Santa Ana, CA 92707

Modernization

Project Description

Chavez High School was originally built in 1991. The site has 12 classrooms. Modernization will address dated infrastructure and Americans with Disabilities Act (ADA) accessibility.

Architect:	SVA Architects
DSA Status:	Approved
Project Status:	Pending State Bond Funds
Measure I Budget	\$692,144
Total Budget:	\$2,239,954

Status Summary

The project was State approved in early 2019 and is currently pending State matching funds. Once funds are allocated by the State Allocation Board, the District will begin bidding and preparation for construction.



Chavez High School

2128 S. Cypress Ave., Santa Ana, CA 92707

Modernization

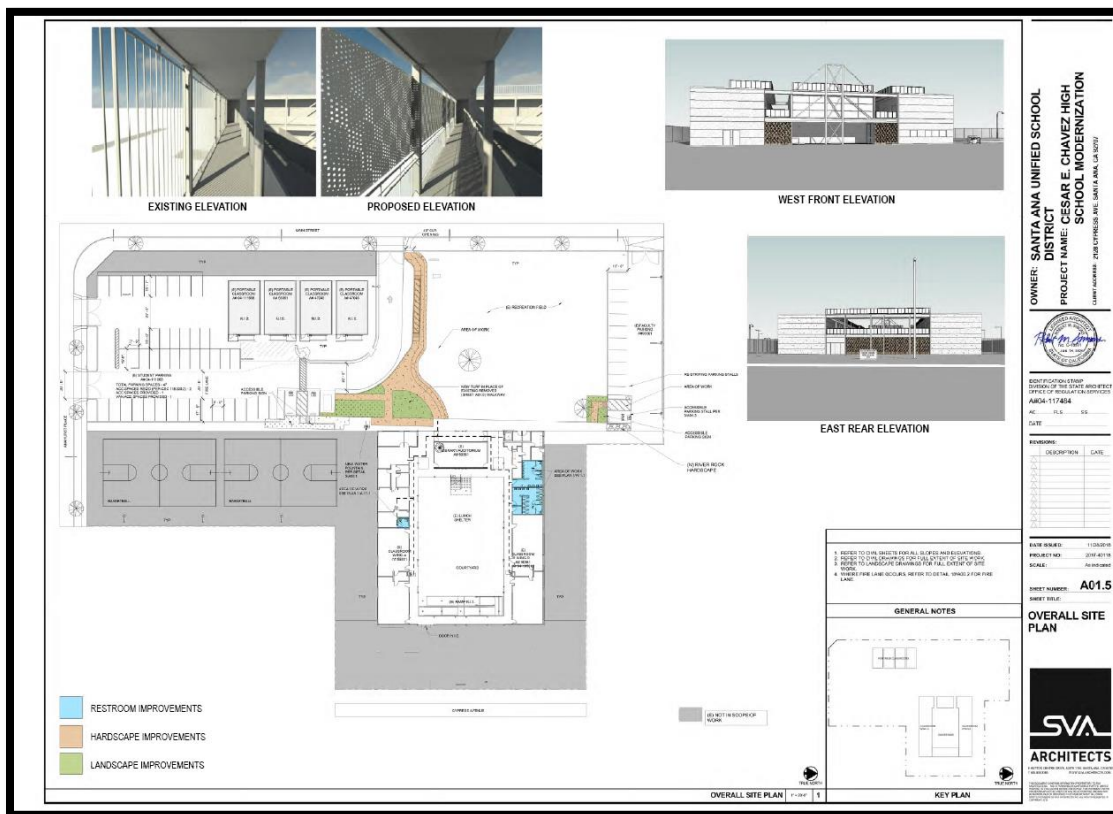



Chavez High School

2128 S. Cypress Ave., Santa Ana, CA 92707

Modernization

Summary Status

Description	Budgeted	Committed	Expended
Site Cost	-	-	-
Soft Cost	416,718	209,242	165,458
Hard Cost	1,528,769	-	-
Contingency	294,468	-	-
Total	2,239,954	209,242	165,458
Budgeted Hard Cost 68%			

Budget Status

Initial Amount	2,239,954
Pending Changes	-
Total	2,239,954
Budgeted Contingency 13%	

Committed Status

Initial Contracted AMT	221,800
Contract Changes	(12,558) -6%
Total	209,242
Budget Committed 9%	

Expenditure Status

Paid	165,458
Total	165,458
Budget Expended 7%	

Progress

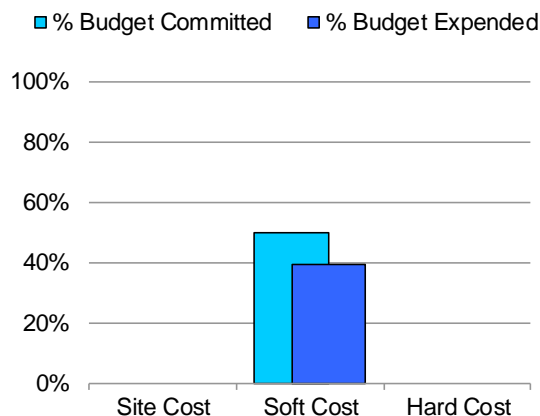

Funding Sources

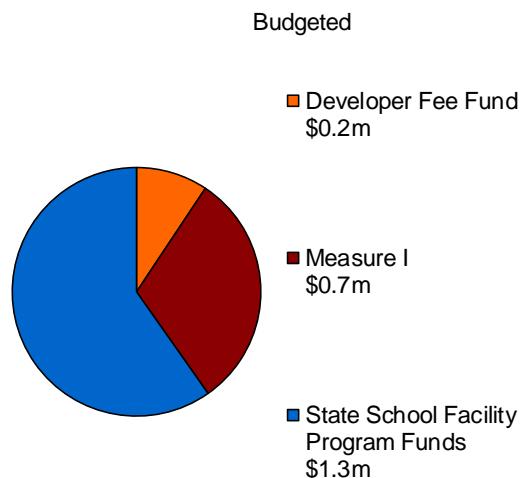



Davis Elementary School

1405 French St. Santa Ana, CA 92701

Modernization

Project Description

Davis Elementary School was originally built in 1957. The site has 33 classrooms. Modernization will address dated infrastructure and Americans with Disabilities Act (ADA) accessibility.

Architect:	SVA Architects
DSA Status:	Approved
Project Status:	Pending State Bond Funds
Measure I Budget:	\$1,797,767
Total Budget:	\$5,647,960

Status Summary

The project was State approved in early 2019 and is currently pending State matching funds. Once funds are allocated by the State Allocation Board, the District will begin bidding and preparation for construction.



Davis Elementary School

1405 French St. Santa Ana, CA 92701

Modernization

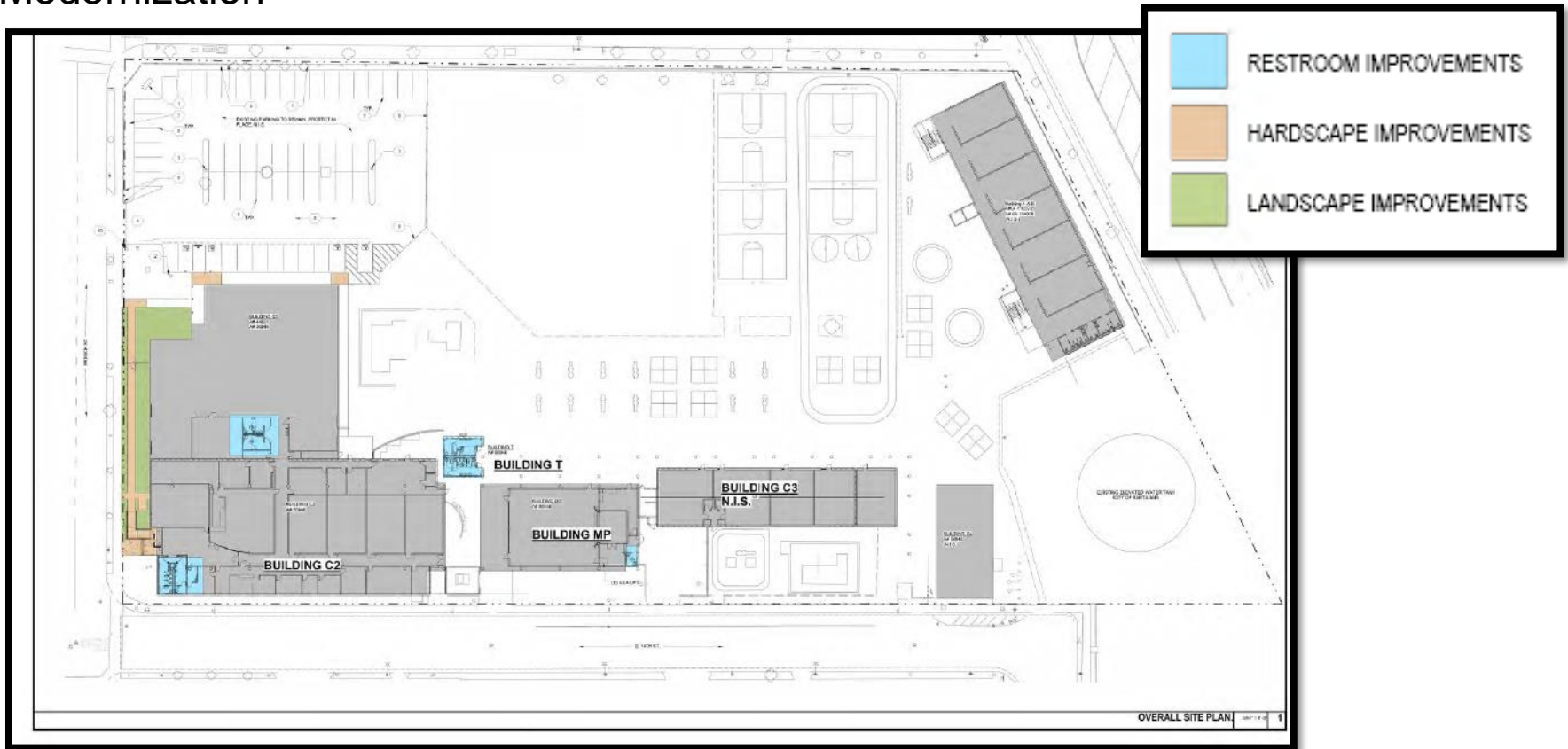



Davis Elementary School

1405 French St. Santa Ana, CA 92701

Modernization

Summary Status

Description	Budgeted	Committed	Expended
Site Cost	-	-	-
Soft Cost	986,299	478,620	363,749
Hard Cost	3,854,733	47,000	47,000
Contingency	806,928	-	-
Total	5,647,960	525,620	410,749
Budgeted Hard Cost 68%			

Budget Status

Initial Amount	5,647,960
Pending Changes	-
Total	5,647,960
Budgeted Contingency 14%	

Committed Status

Initial Contracted AMT	339,771
Contract Changes	185,848 35%
Total	525,620
Budget Committed 9%	

Expenditure Status

Paid	410,749
Total	410,749
Budget Expended 7%	

Progress

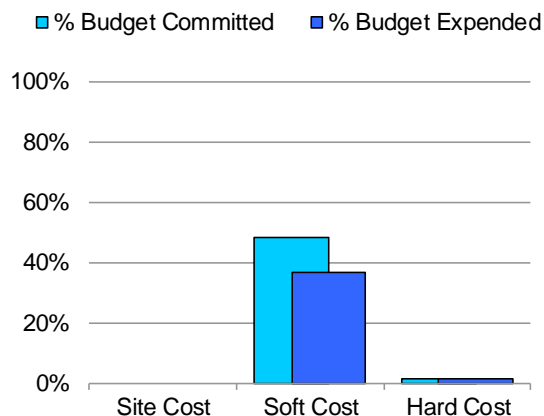

Funding Sources

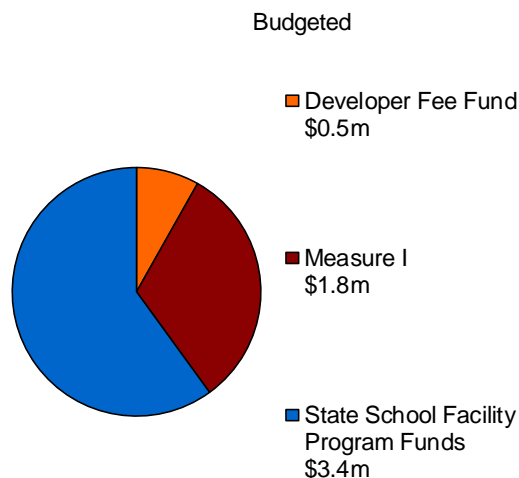



Heninger K-8 School

417 W. Walnut Ave. Santa Ana, CA 92701

Modernization

Project Description

Heninger K-8 School was built in 1992. The site has 41 classrooms. Modernization will address dated infrastructure and ADA accessibility.

Architect:	SVA Architects
DSA Status:	Approved
Project Status:	Pending State Bond Funds
Measure I Budget:	\$1,997,496
Total Budget:	\$6,266,307

Status Summary

The project was State approved in early 2019 and is currently pending State matching funds. Once funds are allocated by the State Allocation Board, the District will begin bidding and preparation for construction.



Heninger K-8 School

417 W. Walnut Ave. Santa Ana, CA 92701

Modernization

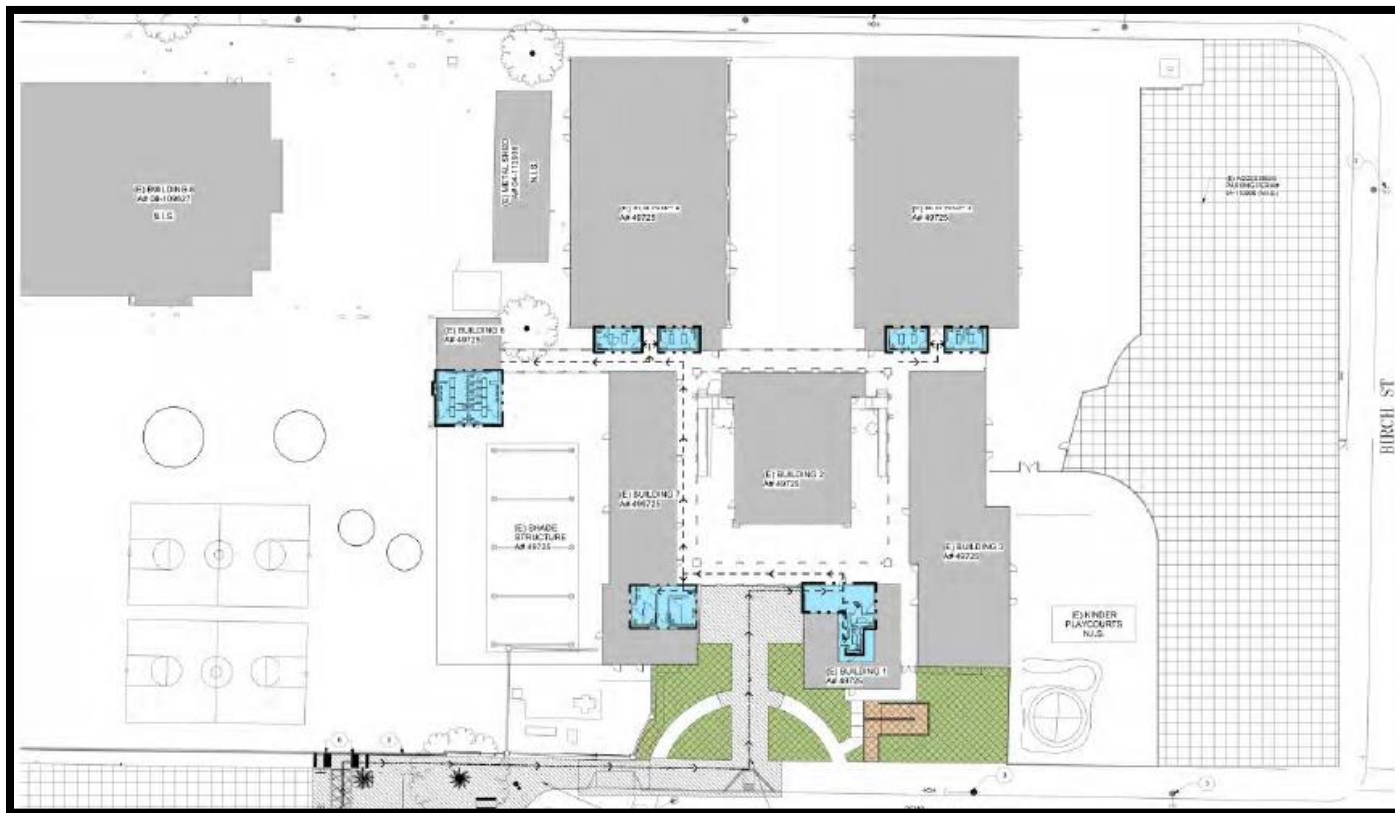



Heninger K-8 School

417 W. Walnut Ave. Santa Ana, CA 92701

Modernization

Summary Status

Description	Budgeted	Committed	Expended
Site Cost	-	-	-
Soft Cost	1,089,707	509,027	390,330
Hard Cost	4,276,755	-	-
Contingency	899,845	-	-
Total	6,266,307	509,027	390,330
Budgeted Hard Cost 68%			

Budget Status

Initial Amount	6,266,307
Pending Changes	-
Total	6,266,307
Budgeted Contingency 14%	

Committed Status

Initial Contracted AMT	495,505
Contract Changes	13,522 3%
Total	509,027
Budget Committed 8%	

Expenditure Status

Paid	379,562
In Process for PMT	10,768
Total	390,330
Budget Expended 6%	

Progress

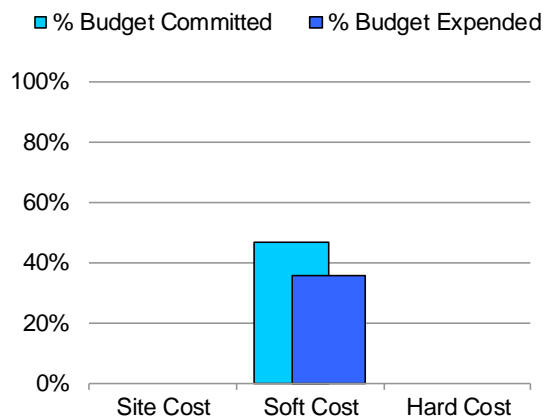

Funding Sources

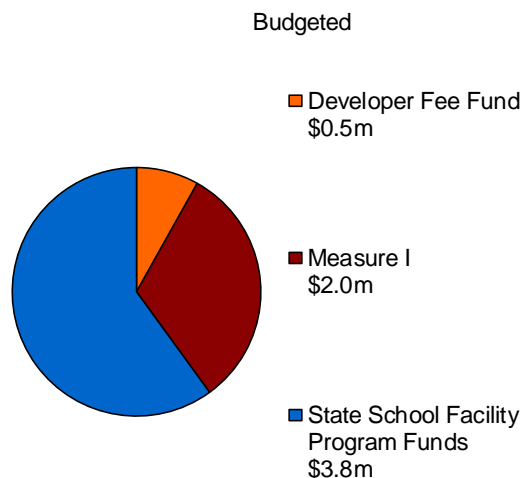



Kennedy Elementary School

1300 E. McFadden Ave. Santa Ana, CA 92705

Modernization

Project Description

Kennedy Elementary School was originally built in 1990. The site has 46 classrooms. Modernization will address dated infrastructure and ADA accessibility.

Architect:	SVA Architects
DSA Status:	Approved
Project Status:	Pending State Bond Funds
Measure I Budget:	\$1,657,094
Total Budget:	\$5,222,614

Status Summary

The project was State approved in early 2019 and is currently pending State matching funds. Once funds are allocated by the State Allocation Board, the District will begin bidding and preparation for construction.



Kennedy Elementary School

1300 E. McFadden Ave. Santa Ana, CA 92705

Modernization

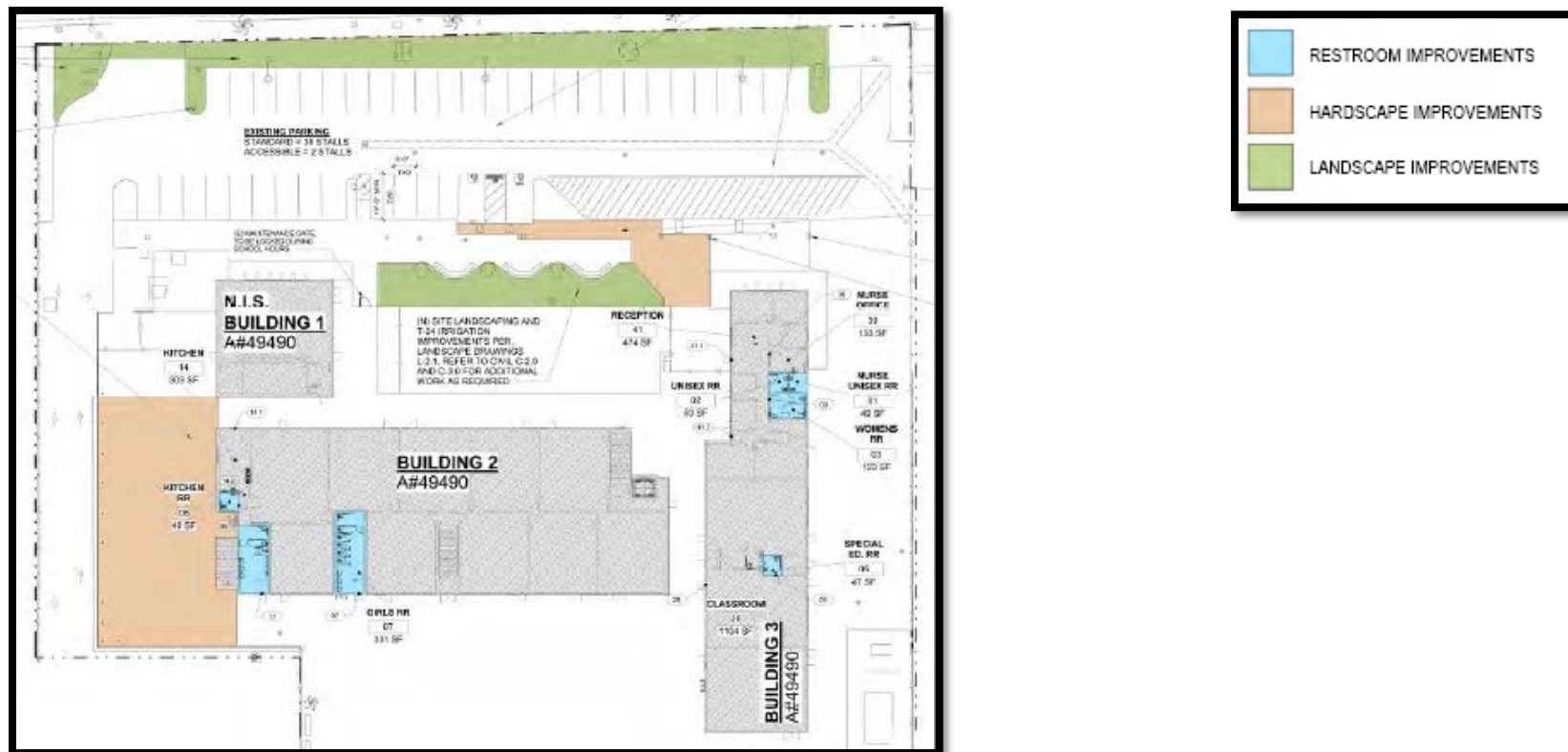



Kennedy Elementary School

1300 E. McFadden Ave. Santa Ana, CA 92705

Modernization

Summary Status

Description	Budgeted	Committed	Expended
Site Cost	-	-	-
Soft Cost	915,697	431,952	329,477
Hard Cost	3,564,434	-	-
Contingency	742,483	-	-
Total	5,222,614	431,952	329,477
Budgeted Hard Cost 68%			

Budget Status

Initial Amount	5,222,614
Pending Changes	-
Total	5,222,614
Budgeted Contingency 14%	

Committed Status

Initial Contracted AMT	260,650
Contract Changes	171,302 40%
Total	431,952
Budget Committed 8%	

Expenditure Status

Paid	321,480
In Process for PMT	7,997
Total	329,477
Budget Expended 6%	

Progress

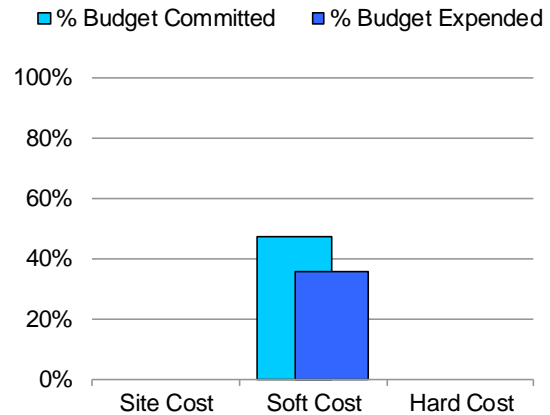

Funding Sources

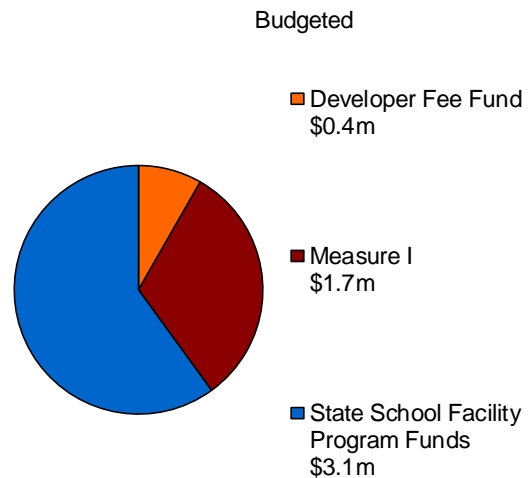



Pio Pico Elementary School

931 W. Highland St. Santa Ana, CA 92705

Modernization

Project Description

Pio Pico Elementary School was originally built in 1991. The site has 22 classrooms. Modernization will address dated infrastructure and ADA accessibility.

Architect:	SVA Architects
DSA Status:	Approved
Project Status:	Pending State Bond Funds
Measure I Budget:	\$1,910,342
Project Budget:	\$6,012,773

Status Summary

The project was State approved in early 2019 and is currently pending State matching funds which are anticipated in 2020 or thereafter. Once funds are allocated by the State Allocation Board, the District will begin bidding and preparation for construction.



Pio Pico Elementary School

931 W. Highland St. Santa Ana, CA 92705

Modernization

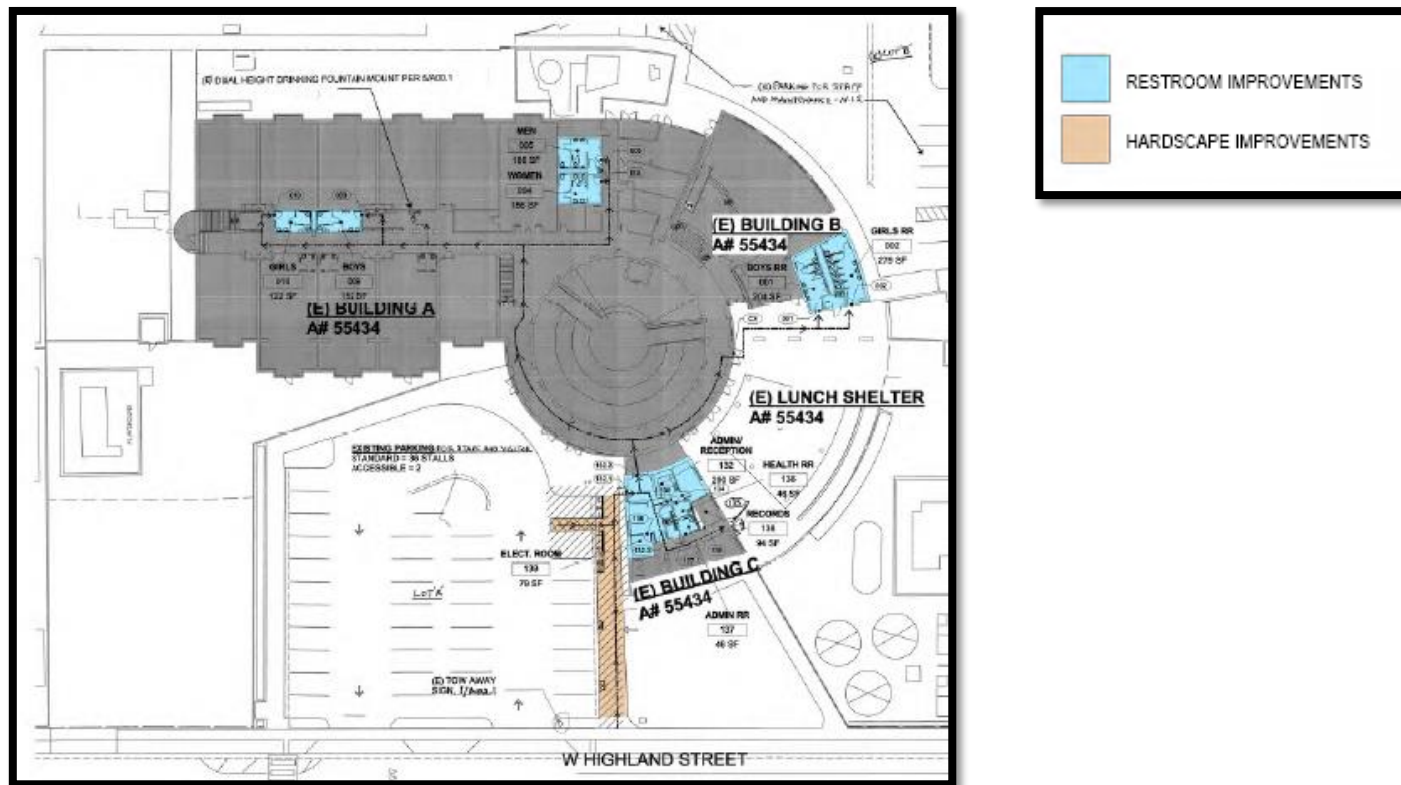



Pio Pico Elementary School

931 W. Highland St. Santa Ana, CA 92705

Modernization

Summary Status

Description	Budgeted	Committed	Expended
Site Cost	-	-	-
Soft Cost	1,051,700	494,767	374,205
Hard Cost	4,103,718	-	-
Contingency	857,355	-	-
Total	6,012,773	494,767	374,205
Budgeted Hard Cost 68%			

Budget Status

Initial Amount	6,012,773
Pending Changes	-
Total	6,012,773
Budgeted Contingency 14%	

Committed Status

Initial Contracted AMT	298,917
Contract Changes	195,850 40%
Total	494,767
Budget Committed 8%	

Expenditure Status

Paid	374,205
Total	374,205
Budget Expended 6%	

Progress

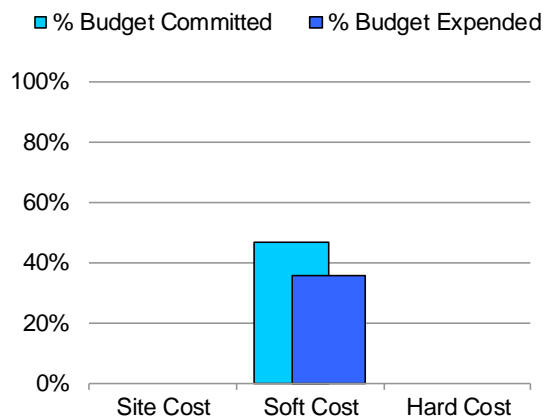

Funding Sources

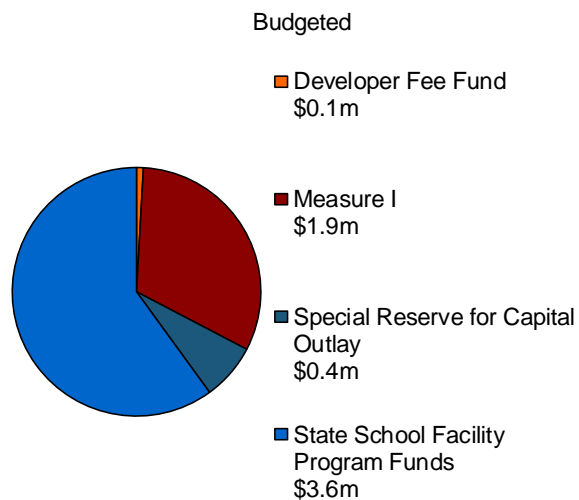



Walker Elementary School

811 E. Bishop Ave. Santa Ana, CA 92707

Modernization

Project Description

Walker Elementary School was originally built in 1993. The site has 23 classrooms. Modernization will address dated infrastructure and Americans with Disabilities Act (ADA) accessibility.

Architect:	SVA Architects
DSA Status:	Approved
Project Status:	Pending State Bond Funds
Measure I Budget:	\$1,172,190
Total Budget:	\$3,740,956

Status Summary

The project was State approved in early 2019 and is currently pending State matching funds which are anticipated in 2020 or thereafter. Once funds are allocated by the State Allocation Board, the District will begin bidding and preparation for construction.



Walker Elementary School

811 E. Bishop Ave. Santa Ana, CA 92707

Modernization

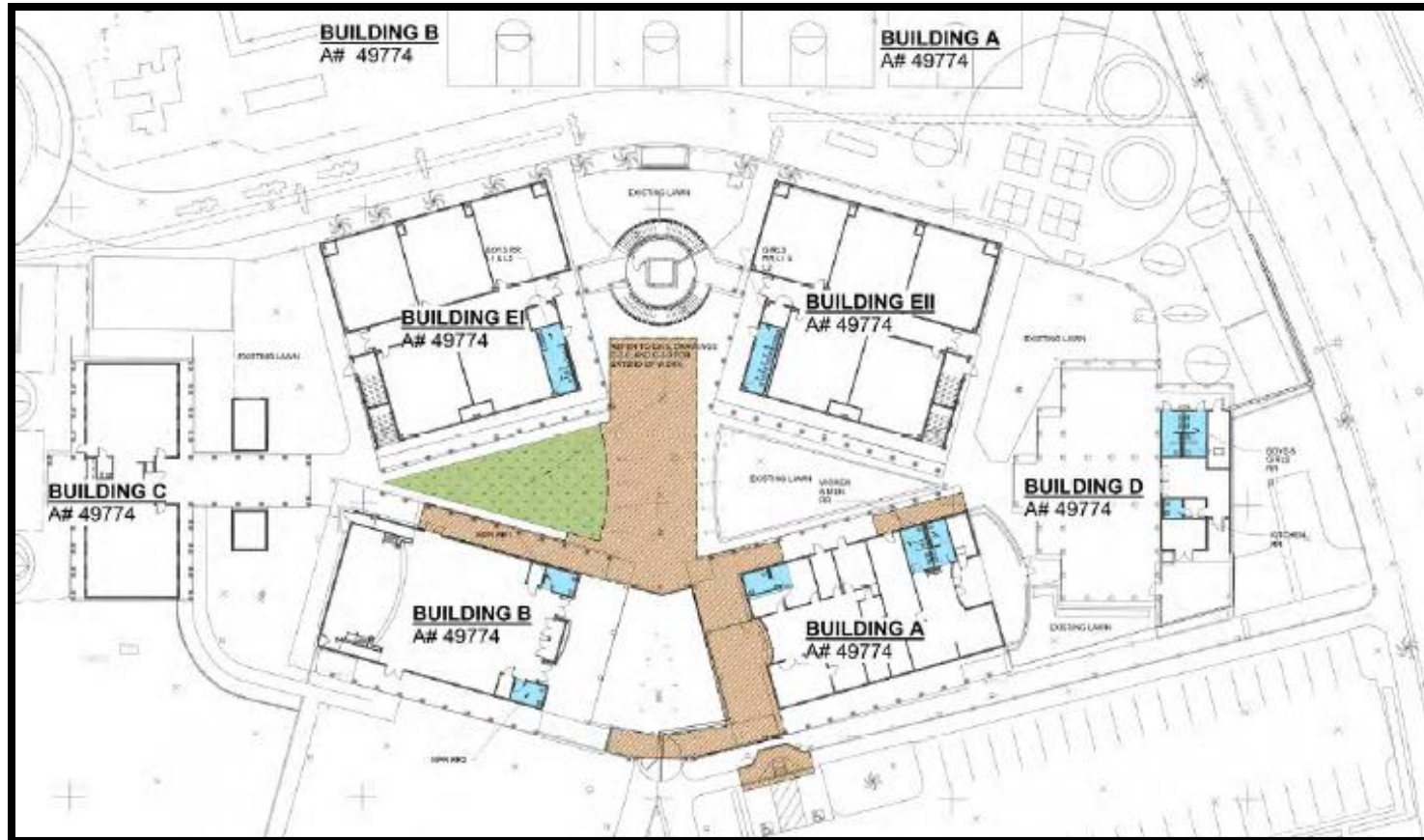



Walker Elementary School

811 E. Bishop Ave. Santa Ana, CA 92707

Modernization

Summary Status

Description	Budgeted	Committed	Expended
Site Cost	-	-	-
Soft Cost	742,218	324,192	241,597
Hard Cost	2,998,738	-	-
Contingency	-	-	-
Total	3,740,956	324,192	241,597
Budgeted Hard Cost 80%			

Budget Status

Initial Amount	3,740,956
Pending Changes	-
Total	3,740,956
Budgeted Contingency 0%	

Committed Status

Initial Contracted AMT	292,050	
Contract Changes	32,142	10%
Total	324,192	
Budget Committed 9%		

Expenditure Status

Paid	241,597
Total	241,597
Budget Expended 6%	

Progress

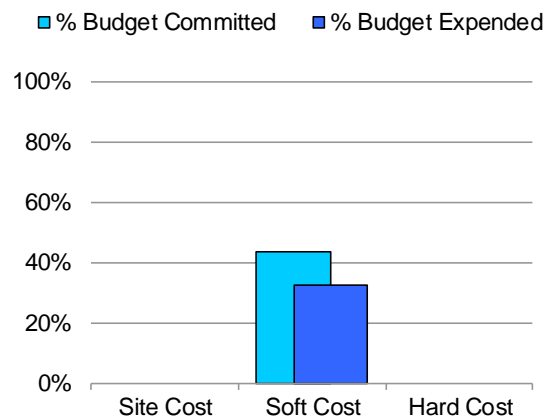

Funding Sources

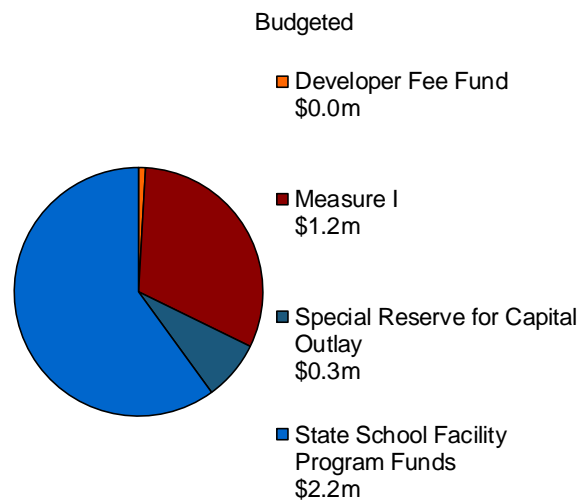



Villa Fundamental Intermediate School

1441 E. Chestnut Ave. Santa Ana, CA 92701

Modernization

Project Description

Villa Fundamental Intermediate School was built in 1998. Modernization will provide new science labs, a new front entry and office, expanded lunch shelter, new HVAC system, Americans with Disabilities Act (ADA) access improvements, and infrastructure upgrades.

Architect:	Baker Nowicki
DSA Status:	Approved
Project Status:	Awaiting State Funding
Measure I Budget:	\$8,487,230
Total Budget:	\$16,399,600

Status Summary

The project was State approved in early July 2019. The Board directed staff to accelerate a portion of the project to address safety, through additional drop-off lanes and an expanded parking lot which were completed in August 2019. An addendum to the plans reflecting these changes is under DSA review. Once State matching funds are allocated by the State Allocation Board, the District may begin bidding and preparation for construction of the campus modernization.



Villa Fundamental Intermediate School

1441 E. Chestnut Ave. Santa Ana, CA 92701

Modernization





Villa Fundamental Intermediate School

1441 E. Chestnut Ave. Santa Ana, CA 92701

Modernization

Summary Status

Description	Budgeted	Committed	Expended
Site Cost	-	-	-
Soft Cost	3,050,399	1,417,882	1,009,257
Hard Cost	11,192,727	-	-
Contingency	2,156,474	-	-
Total	16,399,600	1,417,882	1,009,257
Budgeted Hard Cost 68%			

Budget Status

Initial Amount	16,399,600
Pending Changes	-
Total	16,399,600
Budgeted Contingency 13%	

Committed Status

Initial Contracted AMT	997,606
Contract Changes	420,276 30%
Total	1,417,882
Budget Committed 9%	

Expenditure Status

Paid	1,009,257
Total	1,009,257
Budget Expended 6%	

Progress

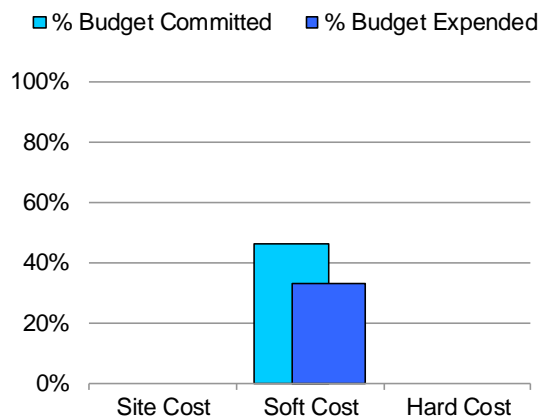

Funding Sources

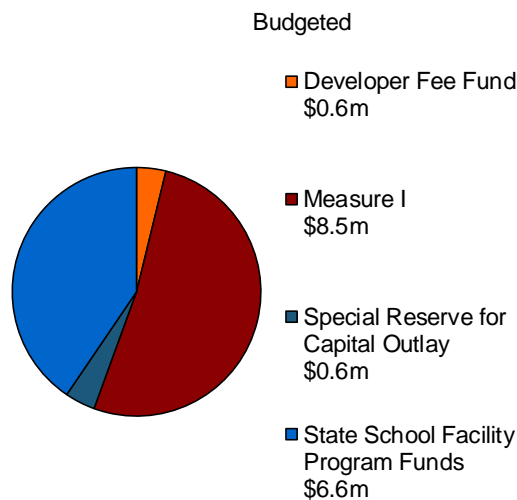



Advanced Learning Academy/ Edward B. Cole

335 E. Walnut St., Santa Ana, CA 92701

Single Point of Entry and New Kitchen Building

Project Description

The Advanced Learning Academy does not have an office with access from outside the school grounds, currently requiring visitors to enter the campus before reaching the front office. To solve this challenge and improve site safety, a new office facility will be established at the Maple Street entrance. Additionally, to improve service to students of both sites, a new kitchen building will be constructed with shared access.

Architect:	Ghataode Bannon Architects
Construction Manager:	On Hold
DSA Status:	Approved
Project Status:	Pending Bidding
Measure I Budget:	\$2,716,290
Total Budget:	\$2,861,340

Status Summary

The project was State approved in spring of 2019. During the summer of 2019, the site was mapped by an underground survey company to identify all existing utility locations in preparation for construction. The survey provides a set of utility drawings for bidding purposes. Bidding will proceed pending receipt of State reimbursement funds on other District projects and subject to Board review of ongoing programs using the campus.



Advanced Learning Academy/ Edward B. Cole

335 E. Walnut St., Santa Ana, CA 92701

Single Point of Entry and New Kitchen Building

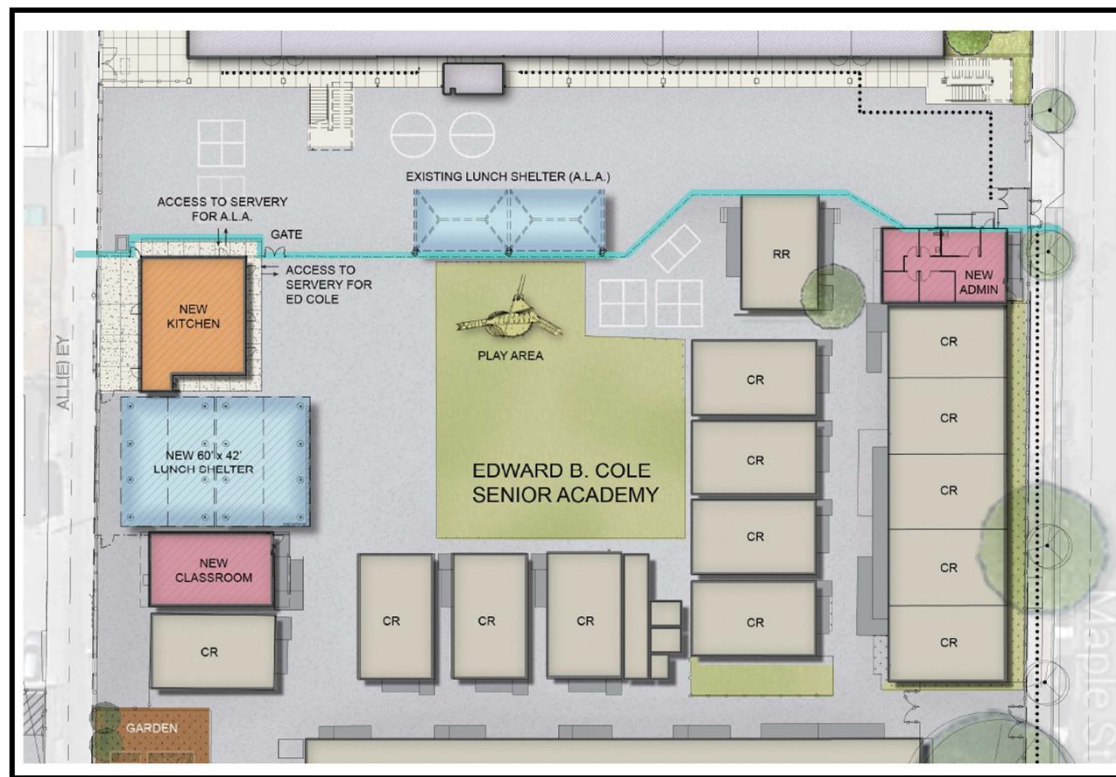



Advanced Learning Academy/ Edward B. Cole

335 E. Walnut St., Santa Ana, CA 92701

Single Point of Entry and New Kitchen Building

Summary Status

Description	Budgeted	Committed	Expended
Site Cost	-	-	-
Soft Cost	585,859	145,050	92,324
Hard Cost	1,952,865	-	-
Contingency	322,616	-	-
Total	2,861,340	145,050	92,324
Budgeted Hard Cost 68%			

Budget Status

Initial Amount	2,861,340
Pending Changes	-
Total	2,861,340
Budgeted Contingency 11%	

Committed Status

Initial Contracted AMT	145,050
Contract Changes	- 0%
Total	145,050
Budget Committed 5%	

Expenditure Status

Paid	92,324
Total	92,324
Budget Expended 3%	

Progress

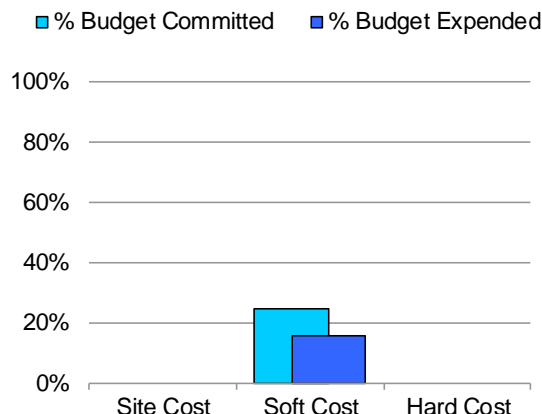

Funding Sources

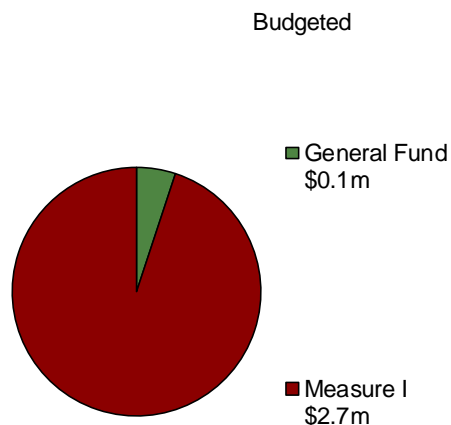



Godinez Fundamental High School

3002 Centennial Rd. Santa Ana, CA 92704

Aquatic Facility

Project Description

Godinez High School was originally built in 2003 without aquatic facilities equitable to other comprehensive high schools. This project will provide a competition style aquatic center for school and community use.

Architect:	Pending
DSA Status:	Pending Submittal
Project Status:	Pending Board Approval of Architect
Measure I Budget:	\$7,000,000
Total Budget:	\$7,000,000

Status Summary

Budget requirements suggest that sufficient Measure I funds are available to complete design and State approval, with construction funded from the second series of Measure I funds.



Godinez Fundamental High School

3002 Centennial Rd. Santa Ana, CA 92704

Aquatic Facility

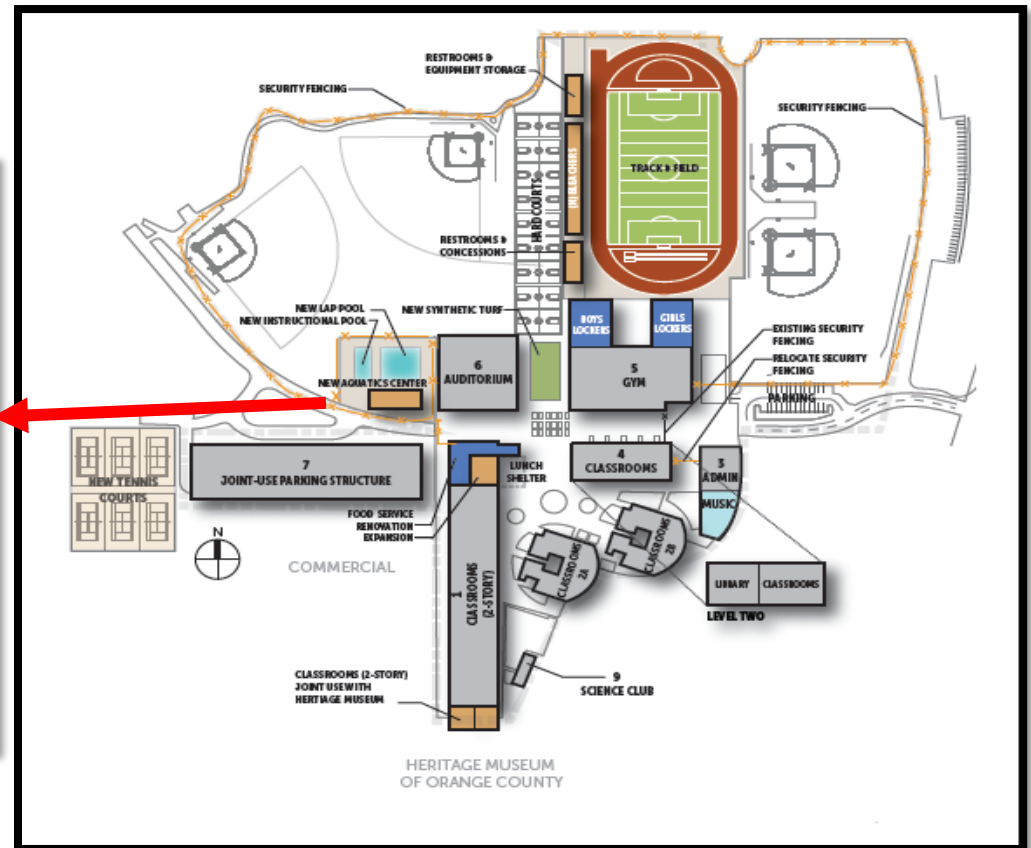
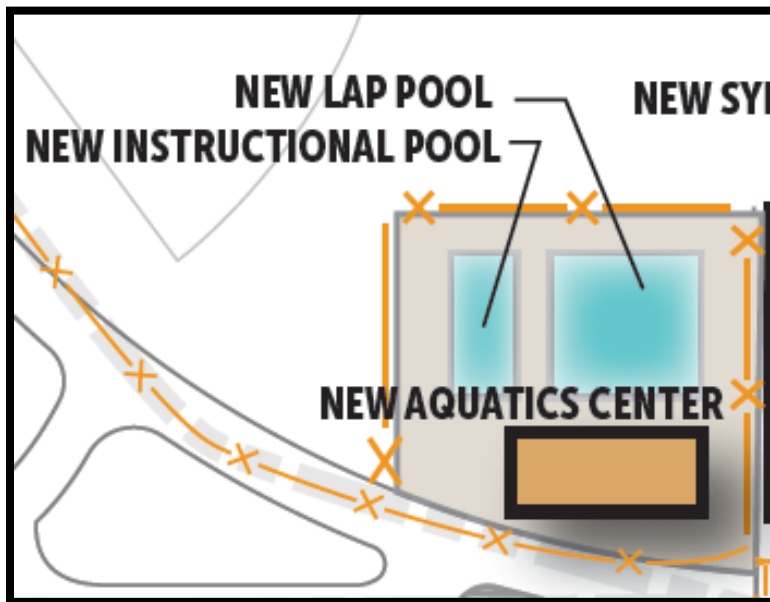



Godinez Fundamental High School

3002 Centennial Rd. Santa Ana, CA 92704

Aquatic Facility

Summary Status

Description	Budgeted	Committed	Expended
Site Cost	-	-	-
Soft Cost	1,160,250	-	-
Hard Cost	4,777,500	-	-
Contingency	1,062,250	-	-
Total	7,000,000	-	-
Budgeted Hard Cost 68%			

Budget Status

Initial Amount	7,000,000
Pending Changes	-
Total	7,000,000
Budgeted Contingency 15%	

Committed Status

No Commitments to report.

Expended Status

No Expenditures to report.

Progress

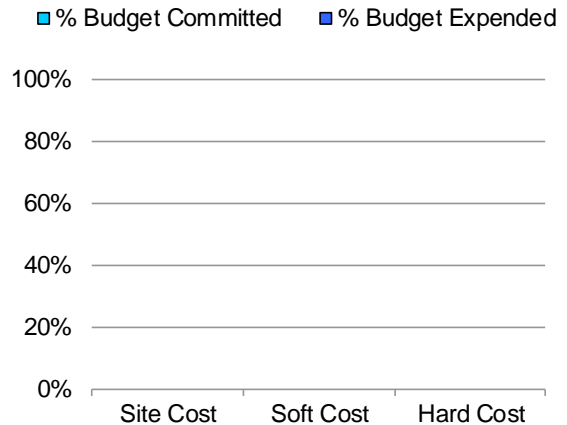

Funding Sources

Budgeted

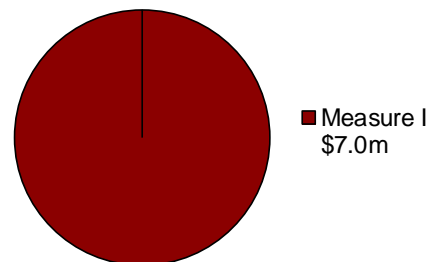



MEASURE I PROGRAM EXECUTIVE SUMMARY

Project	Measure I Budget	Commitments to date	Expenditures to date	Remaining Against Budget	%	Declining Balance
Measure I First Issuance Series A						59,503,000
Interest Revenue						1,411,318
Total Available Fund						60,914,318
Santa Ana High - CTE Digital Media Arts Lab/Library	47,734	47,733	47,733	0	0%	60,866,584
Carver Elementary - P2P	30,820	5,944	5,944	24,876	81%	60,835,764
Muir Fundamental - P2P	759,154	-	-	759,154	100%	60,076,610
Carver Elementary - Modernization	8,815,632	6,549,444	4,110,659	4,704,973	53%	51,260,978
Garfield Elementary - Modernization	7,669,956	6,640,937	615,127	7,054,829	92%	43,591,022
King Elementary - Modernization	6,592,852	207,338	62,201	6,530,651	99%	36,998,170
Saddleback High - Interim and New Kitchen	5,211,505	6,191,133	634,556	4,576,949	88%	31,786,665
Heninger Elementary - K-8 Music Expansion	2,470,795	2,470,794	522,286	1,948,509	79%	29,315,870
District Wide - Marquee (phase I)	1,000,000	146,701	125,151	874,849	87%	28,315,870
Jackson Elementary - Preschool Lab & Playground	1,881,565	1,635,506	439,308	1,442,257	77%	26,434,305
District Wide - Single Point of Entry/Security (phase I)	622,000	171,037	64,789	557,211	90%	25,812,305
Washington Elementary - Reconstruction (design only)	2,044,509	2,014,042	124,764	1,919,745	94%	23,767,796
Saddleback High - Sports Center (design only)	1,233,853	-	-	1,233,853	100%	22,533,943
Valley High - CTE Culinary Arts Building (design only)	844,467	754,897	126,146	2,029,387	94%	21,689,476
Valley High - Auditorium Renovation (design only)	1,900,211	1,853,401	228,629	16,408,161	99%	19,789,265
Jefferson Elementary - P2P/MPR (design only)	2,252,299	1,353,788	112,948	22,134,753	99%	17,536,966
Walker Elementary - Optimization Swing Space	1,788,970	1,635,884	743,781	1,045,189	58%	15,747,996
McFadden Intermediate - Optimization K-8 Conversion (2/3 project total)	5,532,299	532,836	225,751	5,306,548	96%	10,215,697
Sierra Intermediate - Optimization K-8 Conversion (2/3 project total)	4,639,123	462,978	206,394	4,432,730	96%	5,576,574
Romero-Cruz Academy - Primary Playground	1,473,855	-	-	1,473,855	100%	4,102,719
District Wide - Furniture Fixtures & Equipment	903,100	-	-	903,100	100%	3,199,619
Measure I Program Management (2018/19 to 2020/21)	1,930,000	860,928	801,900	1,128,100	58%	1,269,619
Measure I Program Reserves (2018/19 to 2020/21)	702,451	-	-	702,451	100%	567,168



MEASURE I PROGRAM EXECUTIVE SUMMARY

Project	Measure I Budget	Commitments to date	Expenditures to date	Remaining Against Budget	%	Declining Balance
Measure I Second Issuance (Series B): \$80,000,000						
<i>Estimated State Funding for Carver, Garfield and King MOD</i>	(7,224,825)	-	-	(7,224,825)	100%	80,567,168
McFadden Intermediate - Optimization K-8 Conversion (1/3 project total)	2,766,149	-	-	2,766,149	100%	85,025,844
Sierra Intermediate - Optimization K-8 Conversion (1/3 project total)	2,319,562	-	-	2,319,562	100%	82,706,282
Washington Elementary - Reconstruction (construction)	16,422,279	-	-	16,422,279	100%	66,284,003
Washington Elementary - Renovation	6,216,958	-	-	6,216,958	100%	60,067,045
Valley High - CTE Culinary Arts Building (construction)	2,155,533	-	-	2,155,533	100%	57,911,512
Valley High - Auditorium Renovation (construction)	16,636,790	-	-	16,636,790	100%	41,274,722
Jefferson Elementary - P2P/MPR (construction)	22,247,701	-	-	22,247,701	100%	19,027,021
District Wide - Marquee (phase II)	1,000,000	-	-	1,000,000	100%	18,027,021
District Wide - Single Point of Entry/Security (phase II)	4,619,115	-	-	4,619,115	100%	13,407,906
Matching Fund Reserve for CTE Grant	3,000,000	-	-	3,000,000	100%	10,407,906
Measure I Program Management (2021/22 to 2023/24)	3,750,000	-	-	3,750,000	100%	6,657,906
Measure I Program Reserves (2021/22 to 2023/24)	8,000,000	-	-	8,000,000	100%	(1,342,094)
Measure I Third Issuance (Series C): \$46,000,000						
District Wide - Single Point of Entry/Security (phase III)	4,619,115	-	-	4,619,115	100%	44,657,906
Saddleback High - Sports Center (construction)	16,760,237	-	-	16,760,237	100%	40,038,792
Century High - Modernization	5,849,163	-	-	5,849,163	100%	23,278,555
Santa Ana High - Modernization	6,259,505	-	-	6,259,505	100%	17,429,392
Measure I Program Management (2024/25 to 2026/27)	4,075,000	-	-	4,075,000	100%	11,169,887
Measure I Program Reserves (2024/25 to 2026/27)	4,600,000	-	-	4,600,000	100%	7,094,887
Measure I Fourth Issuance (Series D): \$46,000,000						
District Wide - Single Point of Entry/Security (phase IV)	4,619,115	-	-	4,619,115	100%	48,494,887
Chavez High - Modernization	692,144	-	-	692,144	100%	43,875,772
Davis Elementary - Modernization	1,797,767	64,203	52,424	1,745,343	97%	43,183,628
Heninger Elementary - Modernization	1,997,496	-	-	1,997,496	100%	41,385,861
Kennedy Elementary - Modernization	1,657,094	-	-	1,657,094	100%	39,388,365
Pio Pico Elementary - Modernization	1,910,342	-	-	1,910,342	100%	37,731,271
Walker Elementary - Modernization	1,172,190	-	-	1,172,190	100%	35,820,929
Villa Fundamental - Modernization	8,487,230	147,850	147,850	8,339,380	98%	34,648,739
ALA I / EB Cole - Single Point of Entry & New Kitchen	2,716,290	-	-	2,716,290	100%	26,161,509
Godinez Fundamental High - Aquatic Facility	7,000,000	-	-	7,000,000	100%	23,445,219
Measure I Program Management (2027/28 to 2029/30)	4,425,000	-	-	4,425,000	100%	16,445,219
Measure I Program Reserves (2027/28 to 2029/30)	4,600,000	-	-	4,600,000	100%	12,020,219
	225,494,099	33,747,373	9,398,340	216,095,758	95.83%	



Citizens' Bond Oversight Committee Quarterly Report – August 10, 2020

DETAILED PROGRAM EXPENDITURES

School Name - Project Name	Measure I			Other Funds			Grand Total		
	Budget	Commitments	Expenditures	Budget	Commitments	Expenditures	Budget	Commitments	Expenditures
Santa Ana High - CTE Digital Media Arts Lab/Library									
Budget Total	47,734	-	-	5,225,635	-	-	5,273,368	-	-
B - Planning Total	-	2,878	2,878	-	499,339	499,339	-	502,217	502,217
C - Construction Total	-	44,855	44,855	-	4,586,993	4,586,993	-	4,631,849	4,631,849
D - Testing Total	-	-	-	-	3,702	3,702	-	3,702	3,702
E - Inspection Total	-	-	-	-	135,600	135,600	-	135,600	135,600
	47,734	47,733	47,733	5,225,635	5,225,635	5,225,635	5,273,368	5,273,368	5,273,368
Carver Elementary - P2P									
Budget Total	30,820	-	-	11,058,338	-	-	11,089,158	-	-
A - Site Total	-	-	-	-	18,259	18,259	-	18,259	18,259
B - Planning Total	-	-	-	-	625,016	618,027	-	625,016	618,027
C - Construction Total	-	5,944	5,944	-	9,988,735	9,988,735	-	9,994,679	9,994,679
E - Inspection Total	-	-	-	-	426,328	390,754	-	426,328	390,754
	30,820	5,944	5,944	11,058,338	11,058,338	11,015,775	11,089,158	11,064,282	11,021,719
Muir Fundamental - P2P									
Budget Total	759,154	-	-	20,000,000	-	-	20,759,154	-	-
B - Planning Total	-	-	-	-	1,065,362	988,775	-	1,065,362	988,775
C - Construction Total	-	-	-	-	17,898,485	14,441,747	-	17,898,485	14,441,747
D - Testing Total	-	-	-	-	129,496	117,445	-	129,496	117,445
E - Inspection Total	-	-	-	-	177,646	154,238	-	177,646	154,238
	759,154	-	-	20,000,000	19,270,989	15,702,205	20,759,154	19,270,989	15,702,205
Carver Elementary - Modernization									
Budget Total	8,815,632	-	-	762,174	-	-	9,577,806	-	-
B - Planning Total	-	4,361	4,361	-	677,044	633,699	-	681,404	638,059
C - Construction Total	-	6,211,583	3,986,953	-	20,750	20,750	-	6,232,333	4,007,703
D - Testing Total	-	1,360	1,360	-	-	-	-	1,360	1,360
E - Inspection Total	-	332,141	117,986	-	-	-	-	332,141	117,986
	8,815,632	6,549,444	4,110,659	762,174	697,794	654,449	9,577,806	7,247,238	4,765,107
Garfield Elementary - Modernization									
Budget Total	7,669,956	-	-	577,513	-	-	8,247,469	-	-
B - Planning Total	-	26,192	5,432	-	556,753	468,660	-	582,945	474,092
C - Construction Total	-	6,440,918	602,974	-	-	-	-	6,440,918	602,974
E - Inspection Total	-	173,827	6,720	-	-	-	-	173,827	6,720
	7,669,956	6,640,937	615,127	577,513	556,753	468,660	8,247,469	7,197,690	1,083,787
ALA I / EB Cole - Single Point of Entry & New Kitchen									
Budget Total	2,716,290	-	-	145,050	-	-	2,861,340	-	-
B - Planning Total	-	-	-	-	145,050	92,324	-	145,050	92,324
	2,716,290	-	-	145,050	145,050	92,324	2,861,340	145,050	92,324
King Elementary - Modernization									
Budget Total	6,592,852	-	-	596,010	-	-	7,188,862	-	-
B - Planning Total	-	-	-	-	596,010	462,568	-	596,010	462,568
C - Construction Total	-	207,338	62,201	-	-	-	-	207,338	62,201
	6,592,852	207,338	62,201	596,010	596,010	462,568	7,188,862	803,348	524,769



Citizens' Bond Oversight Committee Quarterly Report – August 10, 2020

DETAILED PROGRAM EXPENDITURES

School Name - Project Name	Measure I			Other Funds			Grand Total		
	Budget	Commitments	Expenditures	Budget	Commitments	Expenditures	Budget	Commitments	Expenditures
Saddleback High - Interim and New Kitchen									
Budget Total	5,211,505	-	-	7,800,000	-	-	13,011,505	-	-
B - Planning Total	-	-	-	-	973,732	831,393	-	973,732	831,393
C - Construction Total	-	6,182,908	626,331	-	4,941,571	2,351,384	-	11,124,479	2,977,715
D - Testing Total	-	8,225	8,225	-	6,046	4,956	-	14,271	13,181
E - Inspection Total	-	-	-	-	481,143	140,065	-	481,143	140,065
	5,211,505	6,191,133	634,556	7,800,000	6,402,492	3,327,797	13,011,505	12,593,625	3,962,354
Heninger Elementary - K-8 Music Expansion									
Budget Total	2,470,795	-	-	257,326	-	-	2,728,121	-	-
B - Planning Total	-	14,170	13,729	-	257,326	202,058	-	271,496	215,787
C - Construction Total	-	2,223,354	454,875	-	-	-	-	2,223,354	454,875
E - Inspection Total	-	233,270	53,683	-	-	-	-	233,270	53,683
	2,470,795	2,470,794	522,286	257,326	257,326	202,058	2,728,121	2,728,120	724,345
District Wide - Marquee (phase I)									
Budget Total	1,000,000	-	-	-	-	-	1,000,000	-	-
B - Planning Total	-	115,346	93,796	-	-	-	-	115,346	93,796
C - Construction Total	-	31,355	31,355	-	-	-	-	31,355	31,355
	1,000,000	146,701	125,151	-	-	-	1,000,000	146,701	125,151
Jackson Elementary - Preschool Lab & Playground									
Budget Total	1,881,565	-	-	-	-	-	1,881,565	-	-
B - Planning Total	-	156,775	130,707	-	-	-	-	156,775	130,707
C - Construction Total	-	1,410,306	307,461	-	-	-	-	1,410,306	307,461
E - Inspection Total	-	68,425	1,140	-	-	-	-	68,425	1,140
	1,881,565	1,635,506	439,308	-	-	-	1,881,565	1,635,506	439,308
District Wide - Single Point of Entry/Security (phase I)									
Budget Total	622,000	-	-	378,000	-	-	1,000,000	-	-
B - Planning Total	-	167,847	61,599	-	378,000	320,129	-	545,847	381,727
C - Construction Total	-	3,190	3,190	-	-	-	-	3,190	3,190
	622,000	171,037	64,789	378,000	378,000	320,129	1,000,000	549,037	384,917
Washington Elementary - Reconstruction									
Budget Total	18,466,788	-	-	5,191,492	-	-	23,658,280	-	-
B - Planning Total	-	1,492,787	46,575	-	955,491	688,434	-	2,448,278	735,009
C - Construction Total	-	521,255	78,189	-	-	-	-	521,255	78,189
	18,466,788	2,014,042	124,764	5,191,492	955,491	688,434	23,658,280	2,969,533	813,198
Saddleback High - Sports Center									
Budget Total	17,994,090	-	-	1,000,000	-	-	18,994,090	-	-
	17,994,090	-	-	1,000,000	-	-	18,994,090	-	-
Valley High - CTE Culinary Arts Building									
Budget Total	3,000,000	-	-	3,000,000	-	-	6,000,000	-	-
B - Planning Total	-	754,897	126,146	-	-	-	-	754,897	126,146
	3,000,000	754,897	126,146	3,000,000	-	-	6,000,000	754,897	126,146
Valley High - Auditorium Renovation									
Budget Total	18,537,001	-	-	2,400,000	-	-	20,937,001	-	-
B - Planning Total	-	1,853,401	228,629	-	-	-	-	1,853,401	228,629
	18,537,001	1,853,401	228,629	2,400,000	-	-	20,937,001	1,853,401	228,629



Citizens' Bond Oversight Committee Quarterly Report – August 10, 2020

DETAILED PROGRAM EXPENDITURES

School Name - Project Name	Measure I			Other Funds			Grand Total		
	Budget	Commitments	Expenditures	Budget	Commitments	Expenditures	Budget	Commitments	Expenditures
Jefferson Elementary - P2P/MPR									
Budget Total	24,500,000	-	-	-	-	-	24,500,000	-	-
B - Planning Total	-	1,353,788	112,948	-	-	-	-	1,353,788	112,948
	24,500,000	1,353,788	112,948	-	-	-	24,500,000	1,353,788	112,948
Walker Elementary - Measure I Optimization Swing Space									
Budget Total	1,788,970	-	-	-	-	-	1,788,970	-	-
B - Planning Total	-	92,312	86,425	-	-	-	-	92,312	86,425
C - Construction Total	-	1,497,492	644,107	-	-	-	-	1,497,492	644,107
E - Inspection Total	-	46,080	13,250	-	-	-	-	46,080	13,250
	1,788,970	1,635,884	743,781	-	-	-	1,788,970	1,635,884	743,781
McFadden Intermediate - Optimization K-8 Conversion									
Budget Total	8,298,448	-	-	-	-	-	8,298,448	-	-
B - Planning Total	-	222,653	172,709	-	-	-	-	222,653	172,709
C - Construction Total	-	310,183	53,041	-	-	-	-	310,183	53,041
	8,298,448	532,836	225,751	-	-	-	8,298,448	532,836	225,751
Sierra Intermediate - Optimization K8 Conversion									
Budget Total	6,958,685	-	-	-	-	-	6,958,685	-	-
B - Planning Total	-	206,091	160,154	-	-	-	-	206,091	160,154
C - Construction Total	-	256,887	46,240	-	-	-	-	256,887	46,240
	6,958,685	462,978	206,394	-	-	-	6,958,685	462,978	206,394
Romero-Cruz Academy - Primary Playground									
Budget Total	1,473,855	-	-	-	-	-	1,473,855	-	-
	1,473,855	-	-	-	-	-	1,473,855	-	-
District Wide - Furniture Fixtures & Equipment									
Budget Total	903,100	-	-	-	-	-	903,100	-	-
	903,100	-	-	-	-	-	903,100	-	-
Washington Elementary - Renovation									
Budget Total	6,216,958	-	-	-	-	-	6,216,958	-	-
	6,216,958	-	-	-	-	-	6,216,958	-	-
District Wide - Marquee (phase II)									
Budget Total	1,000,000	-	-	-	-	-	1,000,000	-	-
	1,000,000	-	-	-	-	-	1,000,000	-	-
District Wide - Single Point of Entry/Security (phase II, III, IV)									
Budget Total	13,857,344	-	-	-	-	-	13,857,344	-	-
	13,857,344	-	-	-	-	-	13,857,344	-	-
Century High - Modernization									
Budget Total	5,849,163	-	-	13,922,266	-	-	19,771,429	-	-
B - Planning Total	-	-	-	-	2,059,409	1,533,062	-	2,059,409	1,533,062
	5,849,163	-	-	13,922,266	2,059,409	1,533,062	19,771,429	2,059,409	1,533,062
Santa Ana High - Modernization									
Budget Total	6,259,505	-	-	14,740,495	-	-	21,000,000	-	-
B - Planning Total	-	-	-	-	2,140,495	1,573,167	-	2,140,495	1,573,167
	6,259,505	-	-	14,740,495	2,140,495	1,573,167	21,000,000	2,140,495	1,573,167



Citizens' Bond Oversight Committee Quarterly Report – August 10, 2020

DETAILED PROGRAM EXPENDITURES

School Name - Project Name	Measure I			Other Funds			Grand Total		
	Budget	Commitments	Expenditures	Budget	Commitments	Expenditures	Budget	Commitments	Expenditures
Chavez High - Modernization									
Budget Total	692,144	-	-	1,547,810	-	-	2,239,954	-	-
B - Planning Total	-	-	-	-	209,242	165,458	-	209,242	165,458
	692,144	-	-	1,547,810	209,242	165,458	2,239,954	209,242	165,458
Davis Elementary - Modernization									
Budget Total	1,797,767	-	-	3,850,193	-	-	5,647,960	-	-
B - Planning Total	-	-	-	-	461,417	358,325	-	461,417	358,325
C - Construction Total	-	47,000	47,000	-	-	-	-	47,000	47,000
E - Inspection Total	-	17,203	5,424	-	-	-	-	17,203	5,424
	1,797,767	64,203	52,424	3,850,193	461,417	358,325	5,647,960	525,620	410,749
Heninger Elementary - Modernization									
Budget Total	1,997,496	-	-	4,268,811	-	-	6,266,307	-	-
B - Planning Total	-	-	-	-	509,027	390,330	-	509,027	390,330
	1,997,496	-	-	4,268,811	509,027	390,330	6,266,307	509,027	390,330
Kennedy Elementary - Modernization									
Budget Total	1,657,094	-	-	3,565,520	-	-	5,222,614	-	-
B - Planning Total	-	-	-	-	431,952	329,477	-	431,952	329,477
	1,657,094	-	-	3,565,520	431,952	329,477	5,222,614	431,952	329,477
Pio Pico Elementary - Modernization									
Budget Total	1,910,342	-	-	4,102,431	-	-	6,012,773	-	-
B - Planning Total	-	-	-	-	494,767	374,205	-	494,767	374,205
	1,910,342	-	-	4,102,431	494,767	374,205	6,012,773	494,767	374,205
Walker Elementary - Modernization									
Budget Total	1,172,190	-	-	2,568,766	-	-	3,740,956	-	-
B - Planning Total	-	-	-	-	324,192	241,597	-	324,192	241,597
	1,172,190	-	-	2,568,766	324,192	241,597	3,740,956	324,192	241,597
Villa Fundamental - Modernization									
Budget Total	8,487,230	-	-	7,912,370	-	-	16,399,600	-	-
B - Planning Total	-	147,850	147,850	-	1,270,032	861,407	-	1,417,882	1,009,257
	8,487,230	147,850	147,850	7,912,370	1,270,032	861,407	16,399,600	1,417,882	1,009,257
Godinez Fundamental High - Aquatic Facility									
Budget Total	7,000,000	-	-	-	-	-	7,000,000	-	-
	7,000,000	-	-	-	-	-	7,000,000	-	-
Measure I Program Management and Reserves									
Budget Total	35,082,451	-	-	-	-	-	35,082,451	-	-
B - Planning Total	-	860,928	801,900	-	-	-	-	860,928	801,900
	35,082,451	860,928	801,900	-	-	-	35,082,451	860,928	801,900
Sub Totals	232,718,924	33,747,373	9,398,340	114,870,200	53,444,407	43,987,061	347,589,123	87,191,779	53,385,402
Estimated State Funding:									
Carver, Garfield & King MOD	(7,224,825)	-	-	7,224,825	-	-	-	-	-
TOTAL	225,494,099	33,747,373	9,398,340	122,095,025	53,444,407	43,987,061	347,589,123	87,191,779	53,385,402